

Kit 1212

AUDI A4, 4-dr Sedan, 01-04, 05-07 / *02-08

AUDI RS4, 4-dr Sedan, *04-08

AUDI S4, 4-dr Sedan, *04-08

SEAT Exeo, 4-dr Sedan, 09-

*North America

480R
754

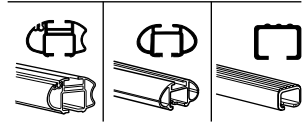
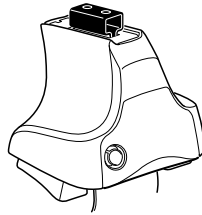

480

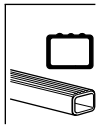
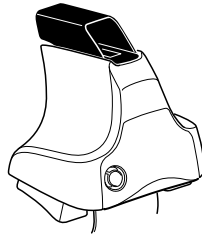

750

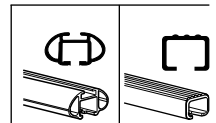
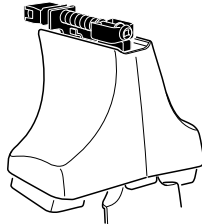

Kit



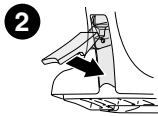
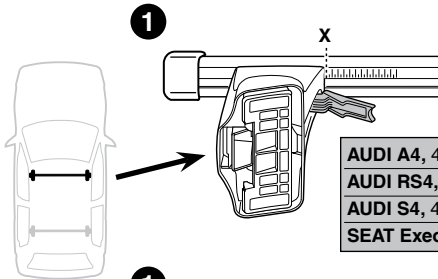
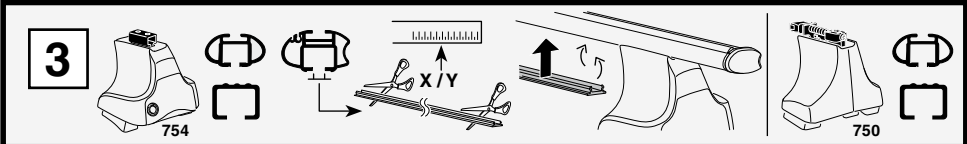

	X
AUDI A4, 4-dr Sedan, 01-04, 05-07 / *02-08	34,5
AUDI RS4, 4-dr Sedan, *04-08	34,5
AUDI S4, 4-dr Sedan, *04-08	34,5
SEAT Exeo, 4-dr Sedan, 09-	34,5

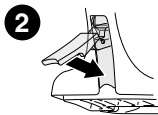
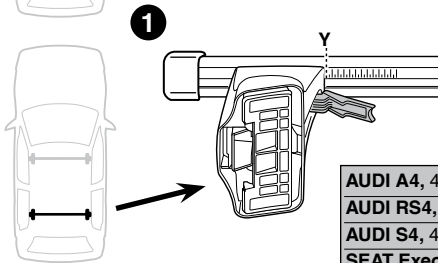

	Y
AUDI A4, 4-dr Sedan, 01-04, 05-07 / *02-08	31
AUDI RS4, 4-dr Sedan, *04-08	31
AUDI S4, 4-dr Sedan, *04-08	31
SEAT Exeo, 4-dr Sedan, 09-	31

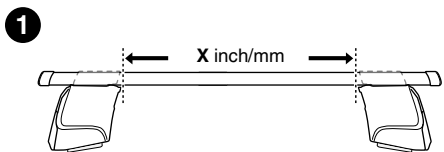
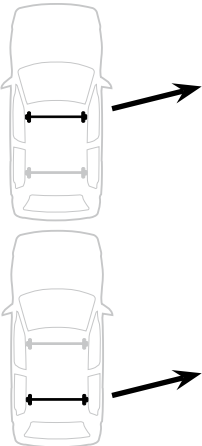
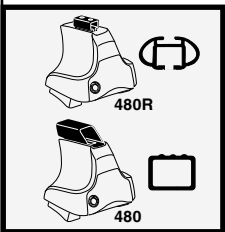

	X inch	X mm
AUDI A4, 4-dr Sedan, 01-04, 05-07 / *02-08	39 1/4"	996 mm
AUDI RS4, 4-dr Sedan, *04-08	39 1/4"	996 mm
AUDI S4, 4-dr Sedan, *04-08	39 1/4"	996 mm
SEAT Exeo, 4-dr Sedan, 09-	39 1/4"	996 mm

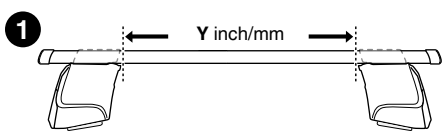

	Y inch	Y mm
AUDI A4, 4-dr Sedan, 01-04, 05-07 / *02-08	37 7/8"	961 mm
AUDI RS4, 4-dr Sedan, *04-08	37 7/8"	961 mm
AUDI S4, 4-dr Sedan, *04-08	37 7/8"	961 mm
SEAT Exeo, 4-dr Sedan, 09-	37 7/8"	961 mm

4

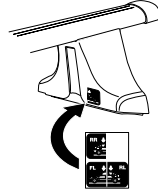
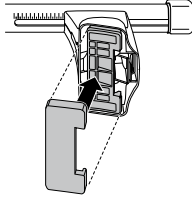
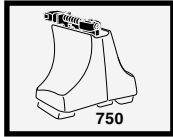
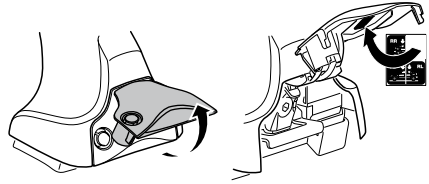
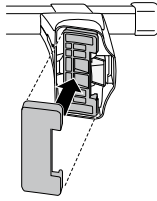
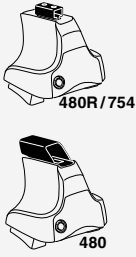

5

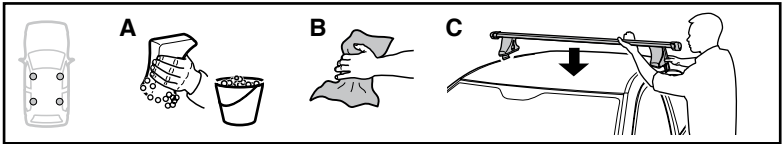

389 x 4

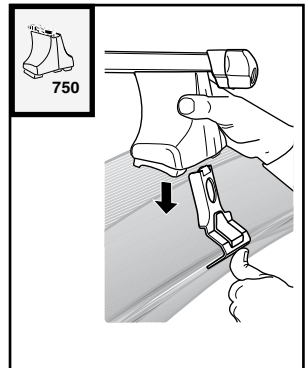
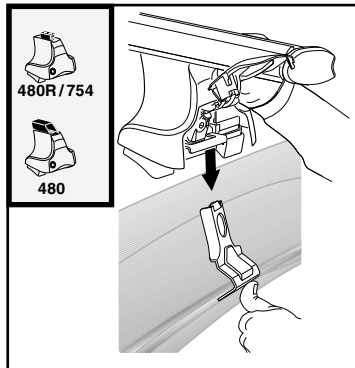
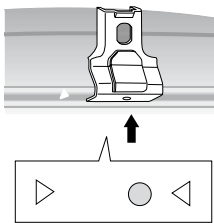
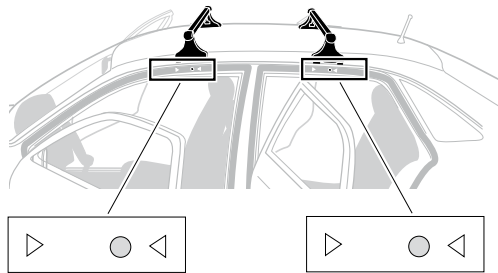

6

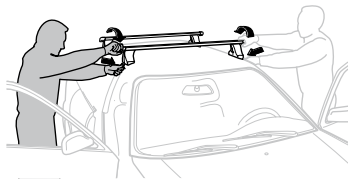
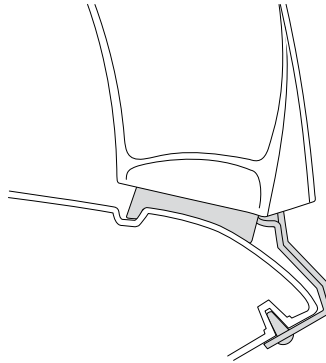
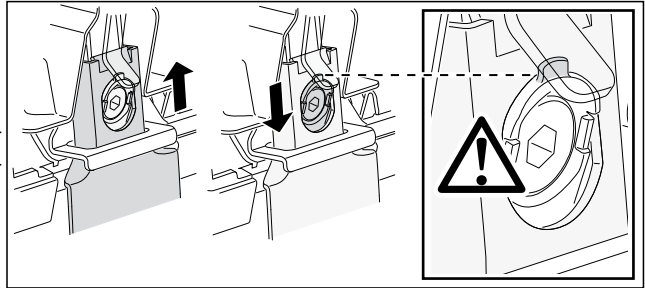
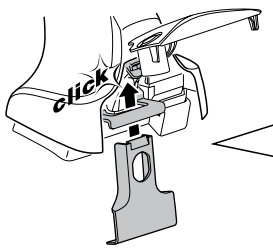

GB/US Tighten alternately

D Die Schrauben abwechselnd anziehen

F Serrer alternativement chaque côté

NL Afwisselend aan de linker- en de rechterkant aandraaien

I Alternare il serraggio delle viti

E Serrare alternativamente

PT Aperte alternadamente

S Dra åt växelvis

FIN Kierrä vuorotellen

EST Pinguldage vaheldumisi

LAT Pielieciet pamišus

LIT Užsukinkite pakaitomis

PL Śruby dokręcaj naprzemiennie

RU Затягивайте попеременно

CZ Pokręťta bagażníka dokręcaj dokręcaj naprzemiennie.

SK Doťahujte striedavo

SLO Privijajte izmenično.

HR Naizmjenično zategnite

HU Egymástól függetlenül szorítandó

GR Σφίγγετε εναλλάξ

TR Dönüşümlü sıkın

中文 交替拧紧

한국어 번갈아 가며 조이십시오.

日本語 交互に締め付けてください。

ไทย ชั้้นในแบบสลับ

7

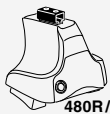

480R/754



480

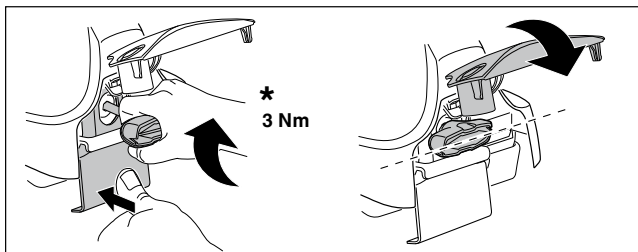
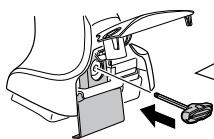

*
3 Nm

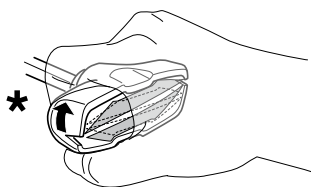

*

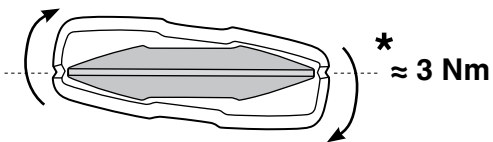

*
≈ 3 Nm

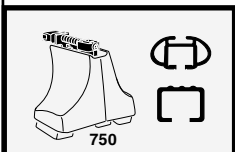
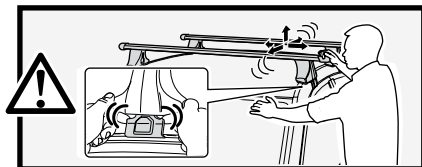

750

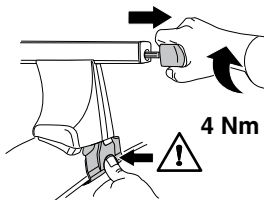

4 Nm

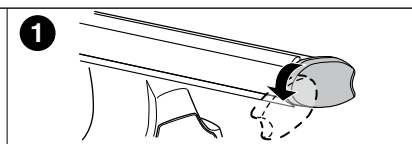
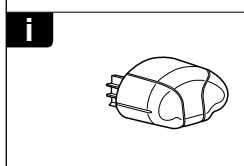
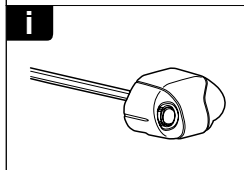
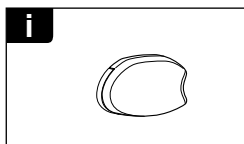
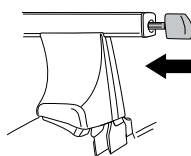

1

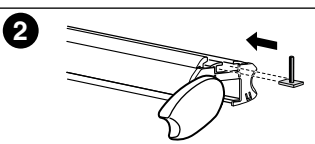

2

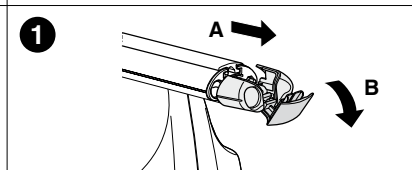

1

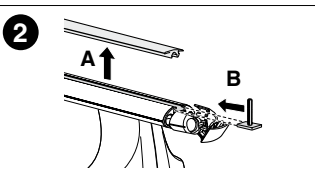

2

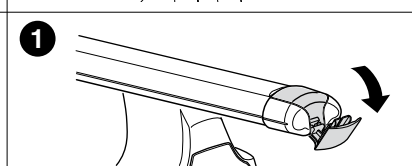

1

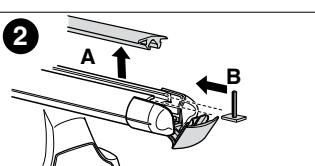

2

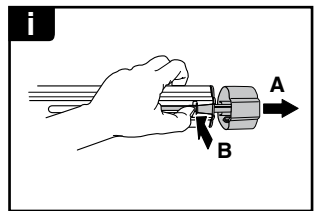
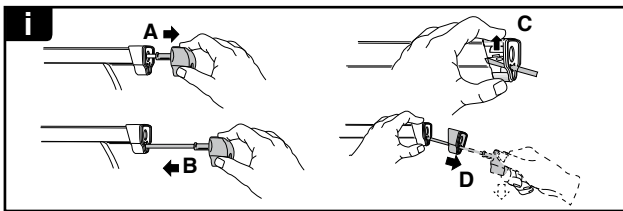
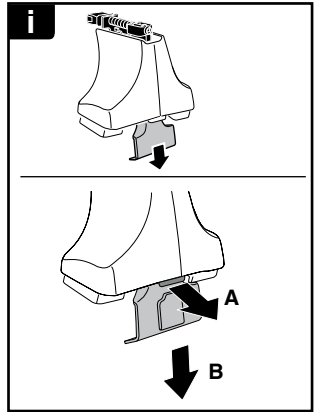
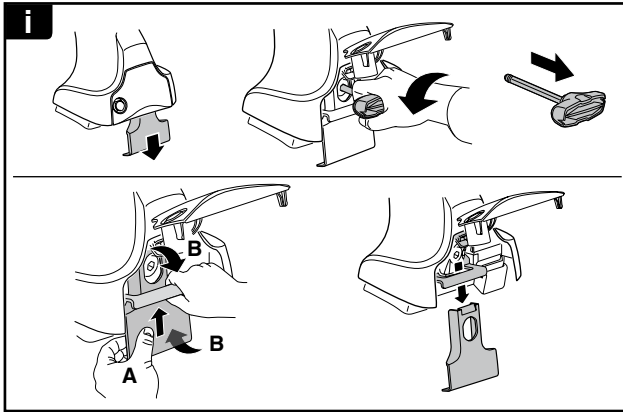

THULE
SWEDEN
**ONE
KEY
SYSTEM**



		544	(x4)
		596	(x6)
		588	(x8)
NA		510	(x10)
EUR		452	(x12)
ASIA			



WW ▶ Thule Sweden AB, Box 69, 330 33 Hillerstorp, SWEDEN
NA ▶ Thule Inc., 42 Silvermine Road, Seymour, Connecticut 06483, USA

info@thule.com
customer.service@thule.com

www.thule.com

503-1212-02