

## ELECTRIC TOOL PARTS LIST

### ■ PLANER

Model P 20SA2

2001-6-1

(E1-1)

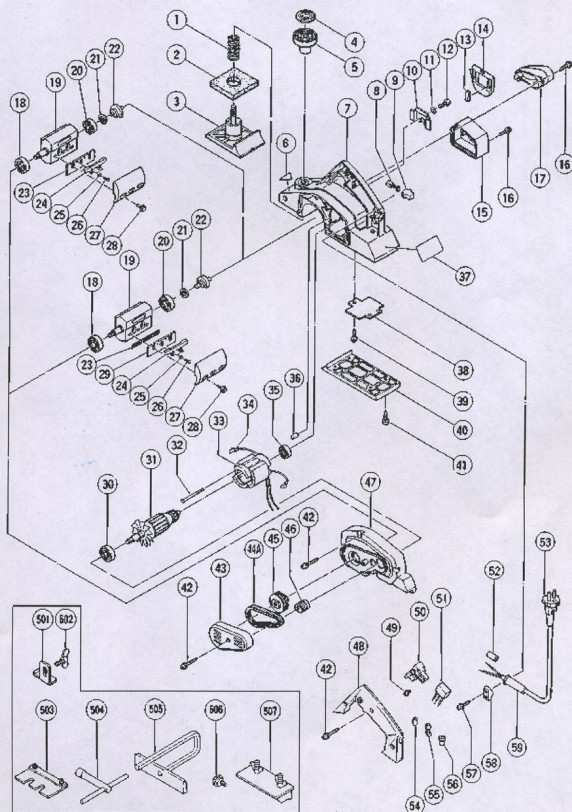

## PARTS

P20SA2

ITEM No.	CODE No.	DESCRIPTION	No. USED	REMARKS
1	958-709	SPRING	1	
2	958-708	RUBBER PACKING	1	
3	958-831Z	FRONT BASE	1	
4	316-417	SCALE	1	
5	942-328	KNOB	1	
6		HITACHI LABEL	1	
7	990-658	HOUSING ASS'Y	1	INCLUD.32,36
8	999-041	CARBON BRUSH (1 PAIR)	2	
9	955-203	BRUSH HOLDER	2	
10	958-838Z	COVER	1	
11	949-453	SPRING WASHER M4 (10 PCS.)	2	
12	949-217	MACHINE SCREW M4X12 (10 PCS.)	2	
13	958-839Z	MAGNET	2	
14	958-837Z	BLADE COVER	1	
15	958-835Z	TAIL COVER	1	
16	307-811	TAPPING SCREW (W/FLANGE) D4X16 (BLACK)	4	
17	958-836Z	CHIP GUIDE	1	
18	620-1VV	BALL BEARING 6201VVCMP2L	1	
19	316-418	CUTTER BLOCK ASS'Y (W/B.B)	1	INCLUD.18,20-22
20	629-VVM	BALL BEARING 629VVC2PS2L	1	
21	958-915	WASHER (A)	1	
22	958-824Z	SHAFT (B)	1	
23	314-746	PLANER BLADES 82MM (1 PAIR)	2	
23	879-418	PLANER BLADES (1 PAIR)	2	FOR NZL,GBR,FRG,FRA,HOL,FIN,AUT,NOR,ESP, SUI
24	314-754	SET PLATE (A)	2	
25	949-423	WASHER M4 (10 PCS.)	4	
26	949-213	MACHINE SCREW M4X5 (10 PCS.)	4	
27	958-850Z	BLADE HOLDER (1 PAIR)	2	
28	990-669	BOLT (WWASHER) M6X18	6	
29	314-740	SET PLATE (B) (1 PAIR)	2	
30	620-0VV	BALL BEARING 6200VVCMP2L	1	
31	990-652C	ARMATURE 110V-127V	1	
31	990-652E	ARMATURE 220V-230V	1	
31	990-652F	ARMATURE 240V	1	
32	963-712	HEX. HD. TAPPING SCREW D4X65	2	
33	990-651K	STATOR ASS'Y 110V	1	INCLUD.34
33	990-651E	STATOR ASS'Y 220V-230V	1	INCLUD.34
33	990-651H	STATOR ASS'Y 240V	1	INCLUD.34

\*ALTERNATIVE PARTS

## PARTS

P20SA2

ITEM No.	CODE No.	DESCRIPTION	No. USED	REMARKS
33	990-651G	STATOR ASS'Y 230V	1	INCLUD.34 FOR NZL
33	990-651J	STATOR ASS'Y 220V-230V	1	INCLUD.34 FOR GBR,SAF,ITA,FRG,FRA,HOL, FIN,AUT,NOR,ESP,SUI
34	941-615	BRUSH TERMINAL	2	
34	958-857Z	BRUSH TERMINAL	2	FOR GBR,SAF,ITA,FRG,FRA,HOL,FIN,AUT,NOR, ESP,SUI
35	608-VVM	BALL BEARING 608VVC2PS2L	1	
36	963-227	BEARING LOCK	1	
37		NAME PLATE	1	
38	958-844Z	PLATE	1	
39	930-446	TAPPING SCREW (W/WASHER) D4X16	1	
40	958-833Z	REAR BASE	1	
41	954-004	TAPPING SCREW D4X16	4	
42	307-028	TAPPING SCREW (W/FLANGE) D4X25 (BLACK)	8	
43	958-830Z	BELT COVER	1	
44A	317-747	BELT	1	
45	990-661	PULLEY (B)	1	
46	990-660	PULLEY (A)	1	
47	990-659	END BRACKET	1	
48	958-854Z	HANDLE COVER	1	
49	305-499	MACHINE SCREW (W/WASHER) M3.5X6	2	
50	957-747	SWITCH (A) (1P SCREW TYPE) W/LOCK	1	
50	971-667Z	SWITCH (2P PILLAR TYPE) W/LOCK	1	FOR SAF
50	963-756Z	SWITCH (2P PILLAR TYPE) W/SAFETY LOCK	1	FOR NZL,AUS,GBR,ITA,FRG,FRA,HOL,FIN,AUT, NOR,ESP,SUI
51	994-273	NOISE SUPPRESSOR	1	FOR NZL,AUS,GBR,SAF,ITA,FRG,FRA,HOL,FIN, AUT,NOR,ESP,SUI
52	981-373	TUBE (D)	2	FOR CORD
53	500-212Z	CORD	1	(CORD ARMOR D8.8)
53	500-439Z	CORD	1	(CORD ARMOR D8.8) FOR NZL,AUS
53	500-435Z	CORD	1	(CORD ARMOR D8.8) FOR GBR (230V)
53	500-247Z	CORD	1	(CORD ARMOR D10.2) FOR FIN,NOR
53	500-234Z	CORD	1	(CORD ARMOR D8.8) FOR ITA,FRG,FRA,HOL, AUT,ESP,SAF
53	500-248Z	CORD	1	(CORD ARMOR D10.2) FOR SUI
53A	500-461Z	CORD	1	(CORD ARMOR D8.8) FOR GBR (110V)
54	981-373	TUBE (D)	2	FOR NZL,GBR,SAF,ITA,FRG,FRA,HOL,FIN,AUT, NOR,ESP,SUI
55	959-144	TERMINAL 50051 (10 PCS.)	1	FOR NOISE SUPPRESSOR



## PARTS

P20SA2

ITEM No.	CODE No.	DESCRIPTION	No. USED	REMARKS
* 56	959-140	CONNECTOR 50091 (10 PCS.)	1	
* 57	984-750	TAPPING SCREW (W/FLANGE) D4X16	2	
* 58	937-631	CORD CLIP	1	
* 59	303-662	CORD ARMOR D8.8	1	
* 59	980-193	CORD ARMOR D10.2	1	

## STANDARD ACCESSORIES

ITEM No.	CODE No.	DESCRIPTION	No. USED	REMARKS
501	958-840Z	DEPTH GUIDE	1	
502	949-395	WING BOLT M5X6 (10 PCS.)	1	
503	316-419	SET GAUGE	1	
504	940-543	BOX WRENCH 10MM	1	
505	958-842Z	GUIDE	1	
506	940-650	STOPPER SCREW M5X14	1	
* 507	314-767	BLADE SHARPENING ASS'Y	1	FOR THA,ITA,HOL