

Kit 1526

BMW X6, 5-dr SUV, 08- / *09-

*North America

480R
754

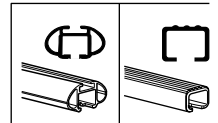
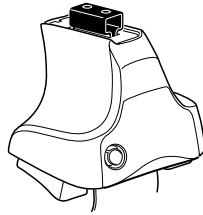

480

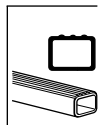
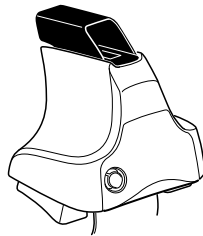

Kit

1

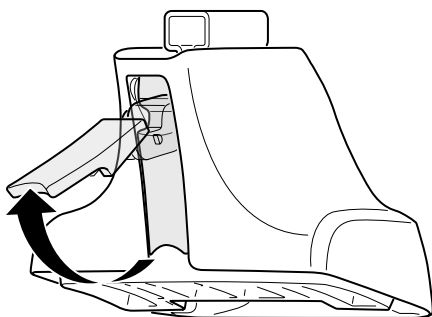
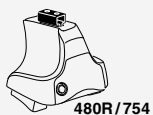

2

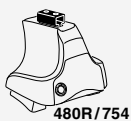

+

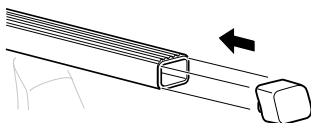
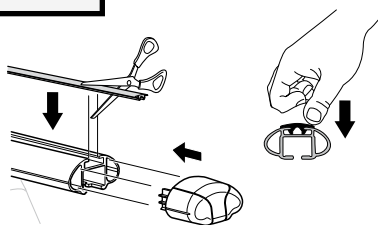
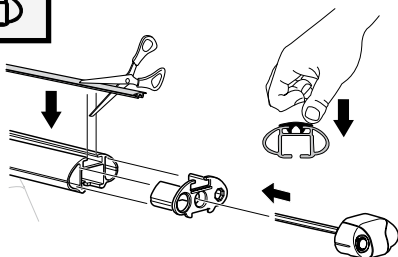
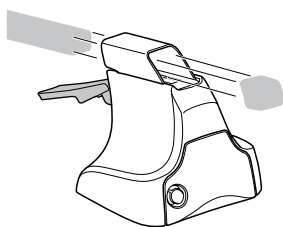
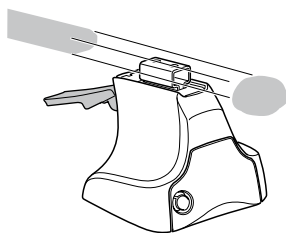

3

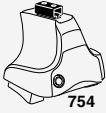

754

1

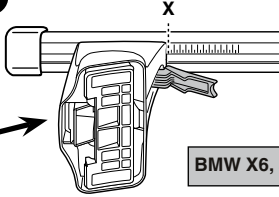
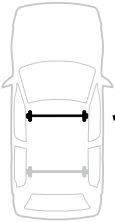

2

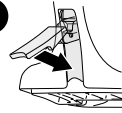

BMW X6, 5-dr SUV, 08- / *09-	X
	44

1

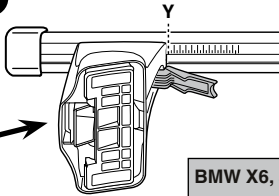

2

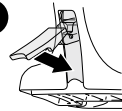

BMW X6, 5-dr SUV, 08- / *09-	Y
	45,5

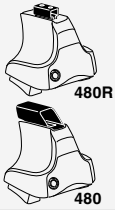

480R

480

1

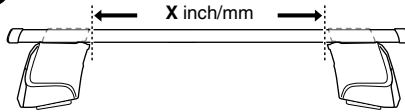

2

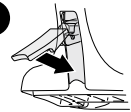

BMW X6, 5-dr SUV, 08- / *09-	X inch	X mm
	43"	1091 mm

1

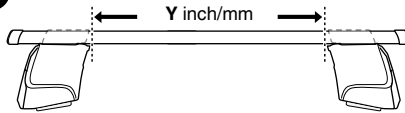

2

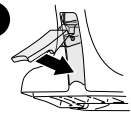

BMW X6, 5-dr SUV, 08- / *09-	Y inch	Y mm
	43 1/2"	1106 mm

4



480R/754



480

BMW X6, 5-dr SUV, 08- / *09-

121

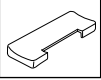

1033



120

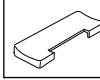

1034



127

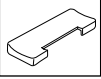

1075



127

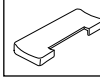

1075

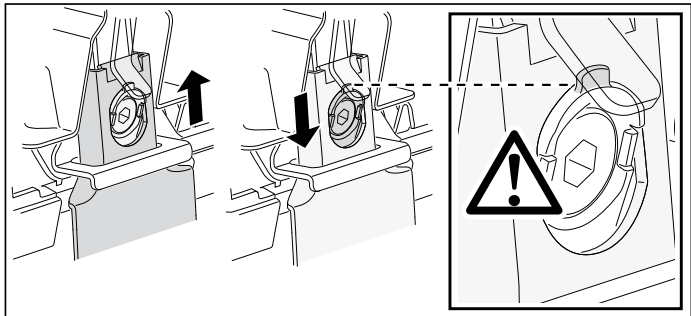
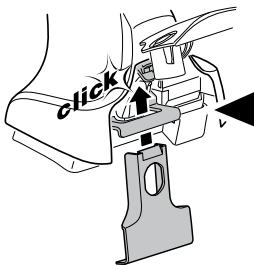
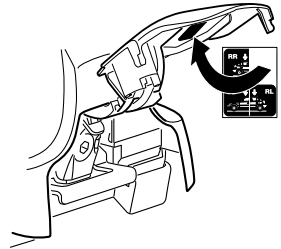
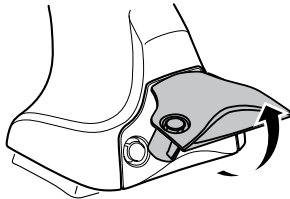
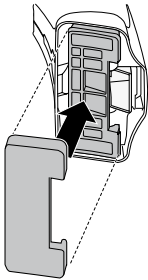

5



	X mm	Y mm	X inch	Y inch
BMW X6, 5-dr SUV, 08- / *09-	230 mm	650 mm	9"	25 5/8"

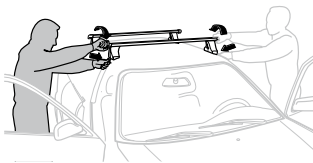
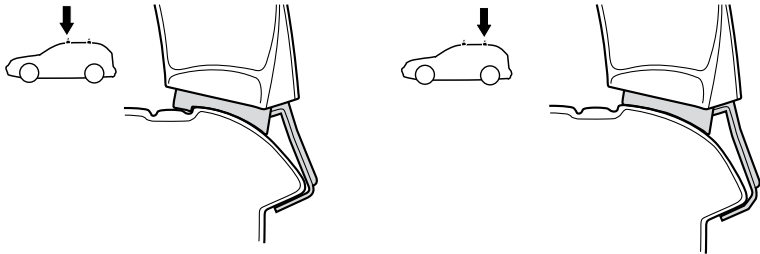
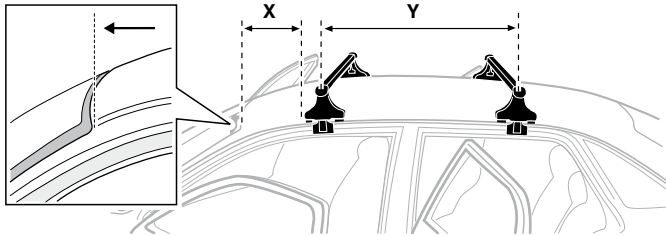

- | | | | |
|--------------|---|------------|---|
| GB/US | Tighten alternately | CZ | Pokřetla bagážníka dokřečaj dokřečaj napřezemennie. |
| D | Die Schrauben abwechselnd anziehen | SK | Dofahujte striedavo |
| F | Serrer alternativement chaque côté | SLO | Privijajte izmenično. |
| NL | Afwisselend aan de linker- en de rechterkant aandraaien | HR | Naizmjenično zategnīte |
| I | Alternare il serraggio delle viti | HU | Egymástól függetlenül szorítandó |
| E | Apretar alternativamente | GR | Σφιγγετε εναλλάξ |
| PT | Aperte alternadamente | TR | Dönüşümlü sıkın |
| S | Dra åt växelvis | 中文 | 交替拧紧 |
| FIN | Kierrä vuorotellen | 한국어 | 번갈아 가며 조이십시오. |
| EST | Pinguldage vaheldumisi | 日本語 | 交互に締め付けてください。 |
| LAT | Pievēlciēt pamišus | ไทย | ขันในแบบสลับ |
| LIT | Užsukinėkite pakaitomis | | |
| PL | Śruby dokręcaj naprzemiennie | | |
| RU | Затягивайте попеременно | | |

6

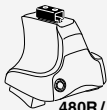

480R/754



480

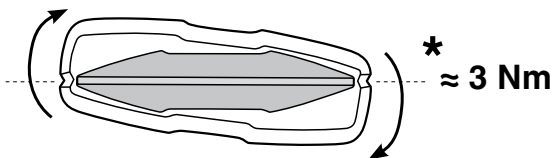
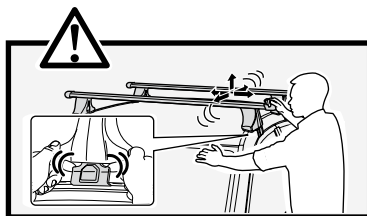
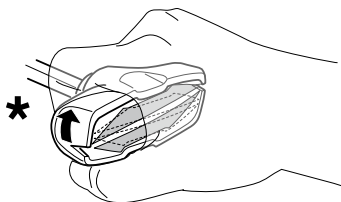
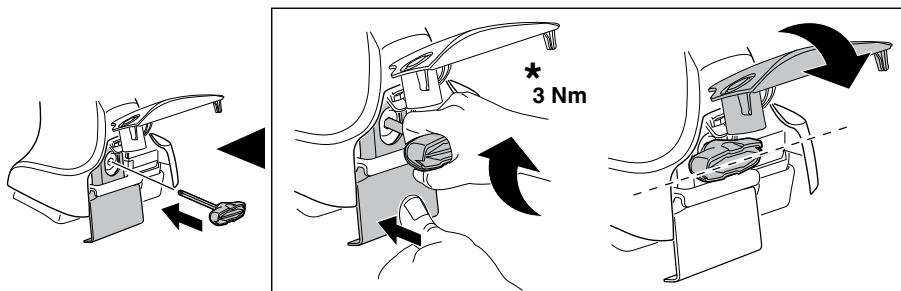

7

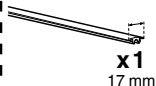

x1
17 mm

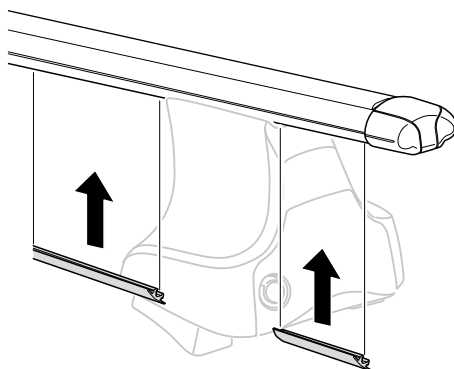

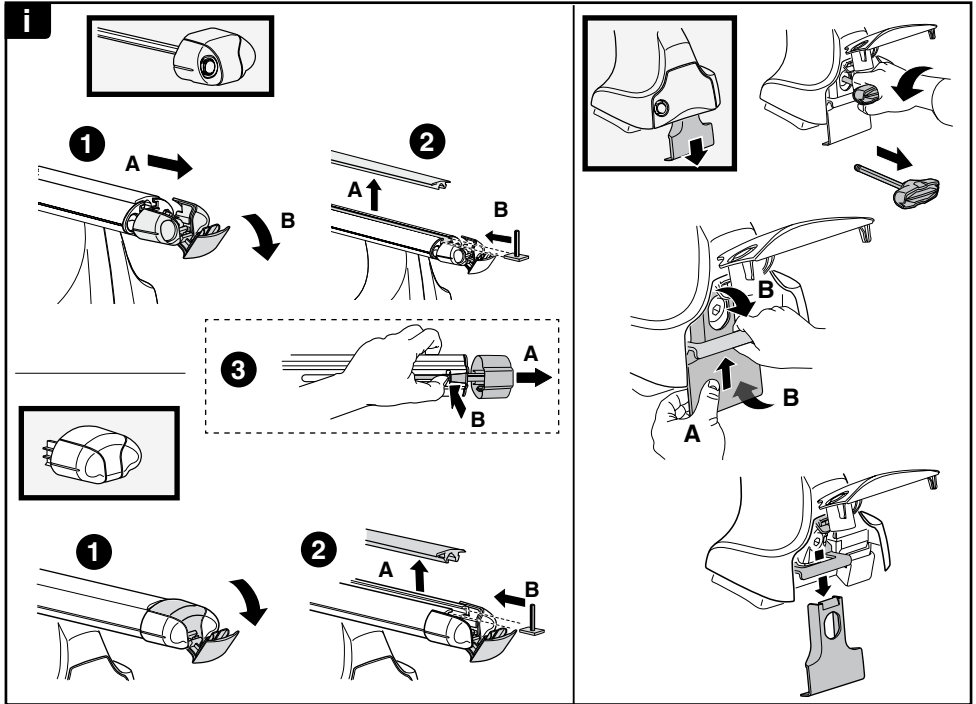
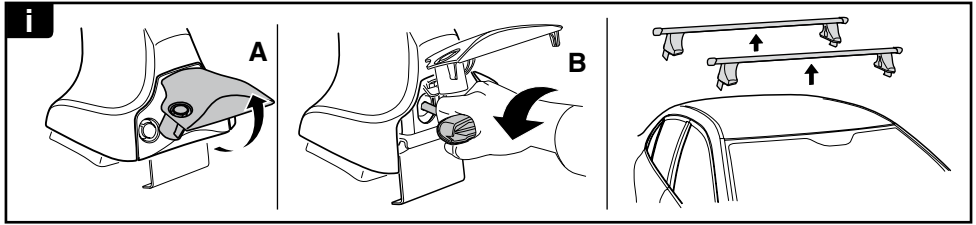

THULE
SWEDEN

**ONE
KEY
SYSTEM**

		544	(x4)
		596	(x6)
		588	(x8)
NA		510	(x10)
EUR		452	(x12)
ASIA			