

Kit 1512

PONTIAC Vibe, 5-dr Hatchback, 03-08, 09–
TOYOTA Matrix, 5-dr Hatchback, 03-08, 09–

This Kit is only for vehicles without factory racks.

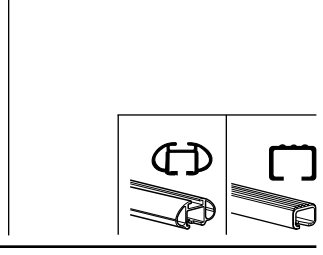
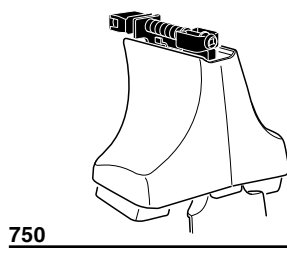
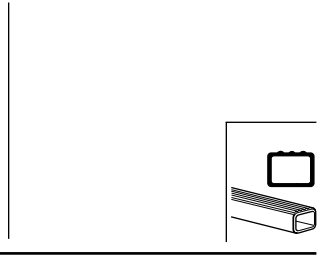
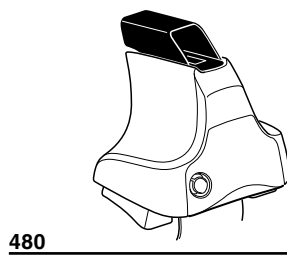
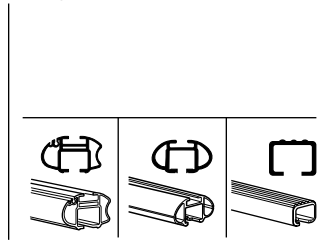
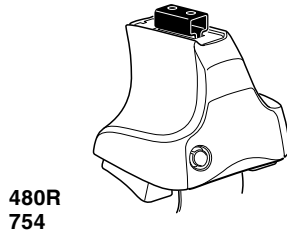

Max. 50 kg
Max. 110 lbs

x1

x4

x4

x4

x4

480R/754

x1

x4

x4

x4

x4

480

x1

x4

x4

x4

x4

750

x2 x2 x2 x4	x2	x2 x2 x4 x4	x2 x2	x2

← **581** x2

← **1037** x2

← **204** x1

← **206** x1

← **171** x2

x1

Kit



3

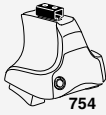

754

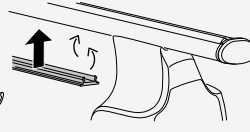
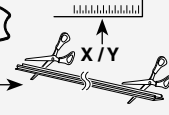

750



1

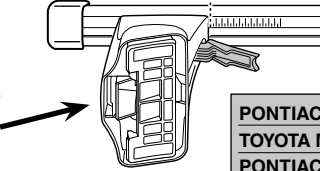
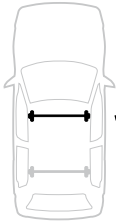

2

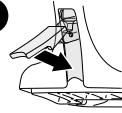

	X
PONTIAC Vibe , 5-dr Hatchback, 03-08	28,5
TOYOTA Matrix , 5-dr Hatchback, 03-08	28,5
PONTIAC Vibe , 5-dr Hatchback, 09–	30
TOYOTA Matrix , 5-dr Hatchback, 09–	30

1

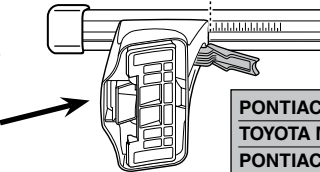

2

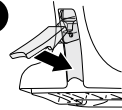

	Y
PONTIAC Vibe , 5-dr Hatchback, 03-08	29,5
TOYOTA Matrix , 5-dr Hatchback, 03-08	29,5
PONTIAC Vibe , 5-dr Hatchback, 09–	34
TOYOTA Matrix , 5-dr Hatchback, 09–	34



480R



480

1

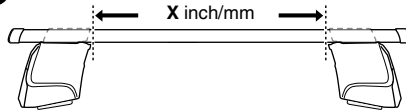

2

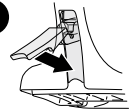

	X inch	X mm
PONTIAC Vibe , 5-dr Hatchback, 03-08	36 3/4"	936 mm
TOYOTA Matrix , 5-dr Hatchback, 03-08	36 3/4"	936 mm
PONTIAC Vibe , 5-dr Hatchback, 09–	37 1/2"	950 mm
TOYOTA Matrix , 5-dr Hatchback, 09–	37 1/2"	950 mm

1

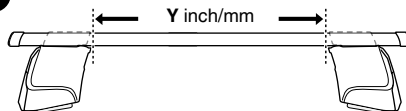

2

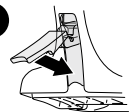

	Y inch	Y mm
PONTIAC Vibe , 5-dr Hatchback, 03-08	37 1/4"	946 mm
TOYOTA Matrix , 5-dr Hatchback, 03-08	37 1/4"	946 mm
PONTIAC Vibe , 5-dr Hatchback, 09–	39"	990 mm
TOYOTA Matrix , 5-dr Hatchback, 09–	39"	990 mm

4

PONTIAC Vibe, 5-dr Hatchback, 03-08, 09-
TOYOTA Matrix, 5-dr Hatchback, 03-08, 09-

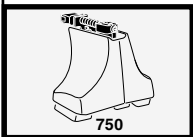
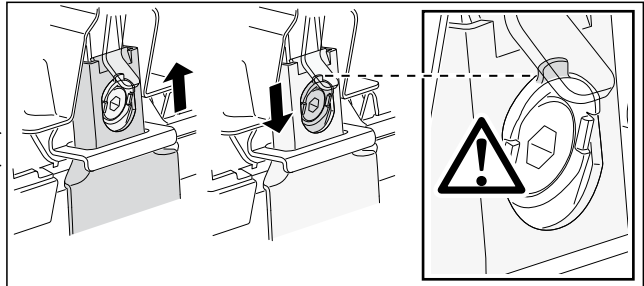
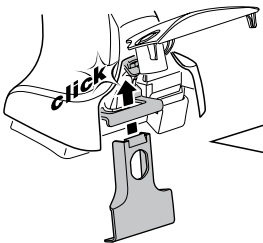
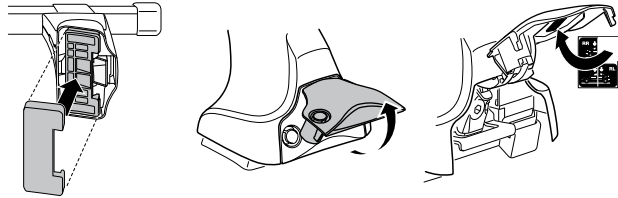
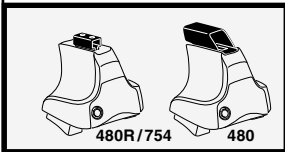
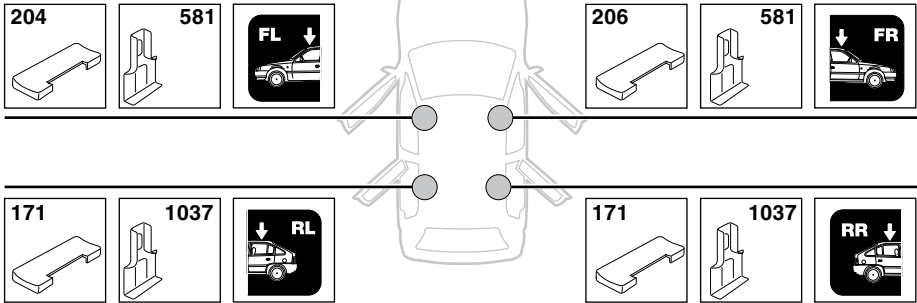

5



	X mm	Y mm	X inch	Y inch
PONTIAC Vibe , 5-dr Hatchback, 03-08	420 mm	665 mm	16 1/2"	26 1/4"
TOYOTA Matrix , 5-dr Hatchback, 03-08	420 mm	665 mm	16 1/2"	26 1/4"
PONTIAC Vibe , 5-dr Hatchback, 09–	380 mm	680 mm	15"	26 3/4"
TOYOTA Matrix , 5-dr Hatchback, 09–	380 mm	680 mm	15"	26 3/4"

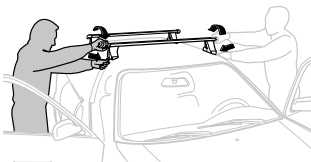
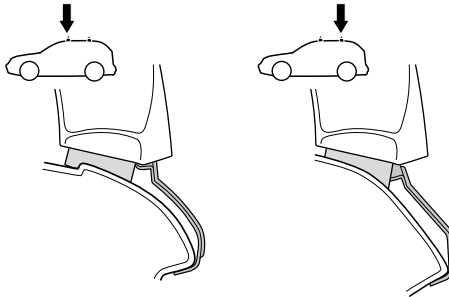
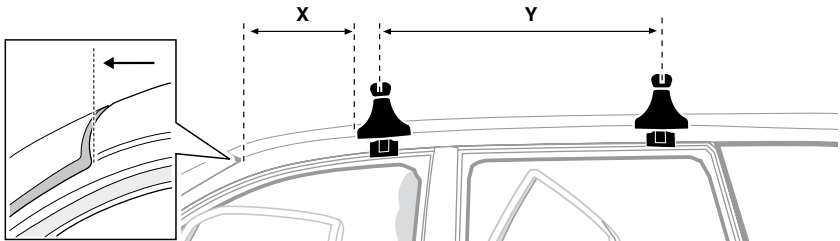

- | | | | |
|--------------|---|------------|---|
| GB/US | Tighten alternately | CZ | Pokřetla багажníka dokřečaj dokřečaj naprzemiennie. |
| D | Die Schrauben abwechselnd anziehen | SK | Dotahujte striedavo |
| F | Serrer alternativement chaque côté | SLO | Privijajte izmenično. |
| NL | Afwisselend aan de linker- en de rechterkant aandraaien | HR | Naizmjenično zategnite |
| I | Alternare il serraggio delle viti | HU | Egymástól függetlenül szorítandó |
| E | Apretar alternativamente | GR | Σφιγίγτε εναλλάξ |
| PT | Aperte alternadamente | TR | Dönüşümlü sıkın |
| S | Dra åt växelvis | 中文 | 交替拧紧 |
| FIN | Kierrä vuorotellen | 한국어 | 번갈아 가며 조이십시오. |
| EST | Pinguldage vaheldumisi | 日本語 | 交互に締め付けてください。 |
| LAT | Pielvelciēt pamišus | ไทย | ขันในแบบสลับ |
| LIT | Užsukinėkite pakaitomis | | |
| PL | Śruby dokřečaj naprzemiennie | | |
| RU | Затягивайте попеременно | | |

6



480R/754



480

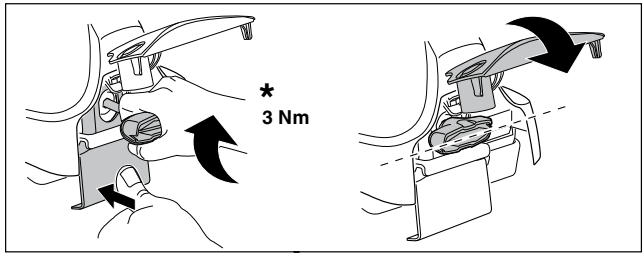
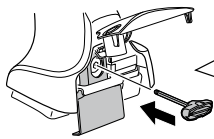

*
3 Nm



*



*
≈ 3 Nm

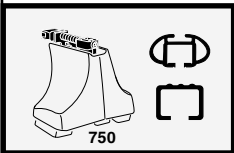

750

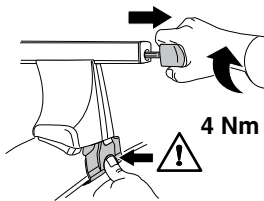

4 Nm

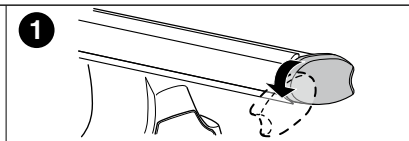
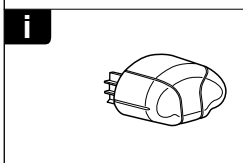
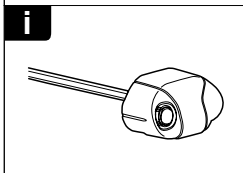
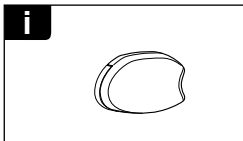
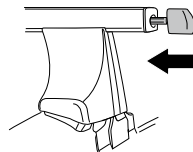

1

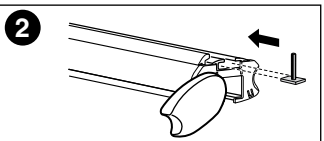

2

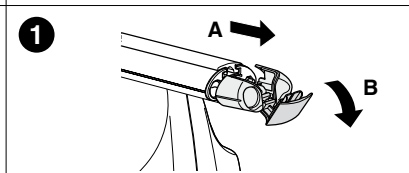

1

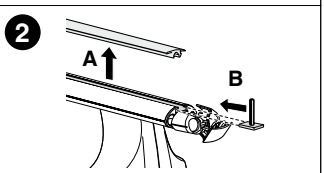

2

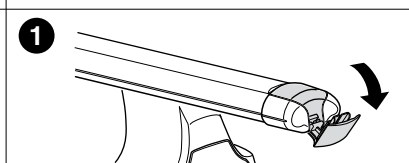

1

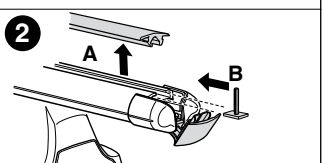

2

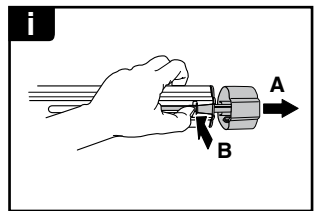
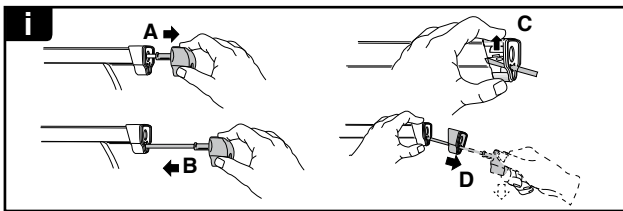
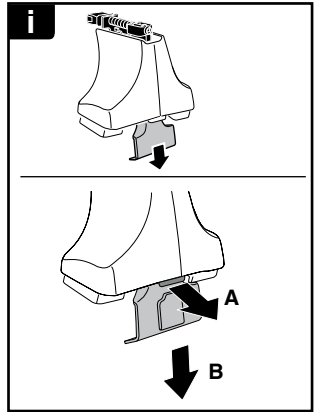
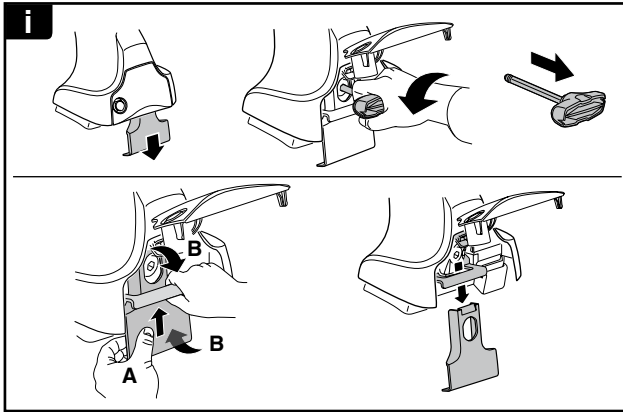

THULE
SWEDEN
**ONE
KEY
SYSTEM**



- 544 (x4)
- 596 (x6)
- 588 (x8)
- NA 510 (x10)
- EUR 452 (x12)
- ASIA

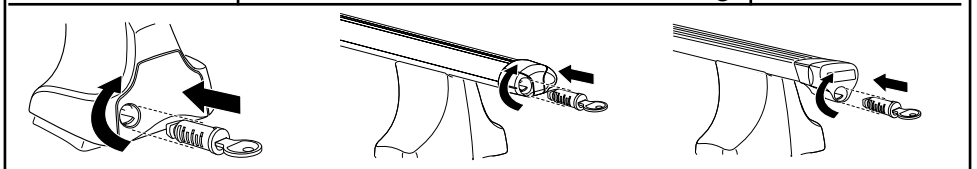

WW ▶ Thule Sweden AB, Box 69, 330 33 Hillerstorp, SWEDEN
NA ▶ Thule Inc., 42 Silvermine Road, Seymour, Connecticut 06483, USA

info@thule.com
customer.service@thule.com

www.thule.com

503-1512-02