

Kit 1454

NISSAN Dualis, 5-dr SUV, 07–
NISSAN Qashqai, 5-dr SUV, 07–

480R
754

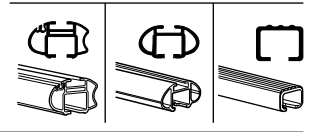
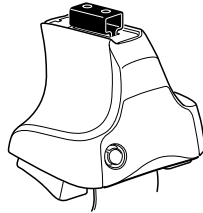

480

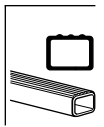
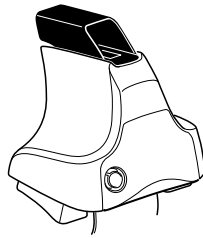

750

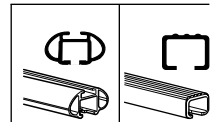
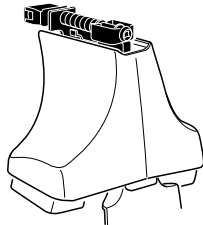

Kit

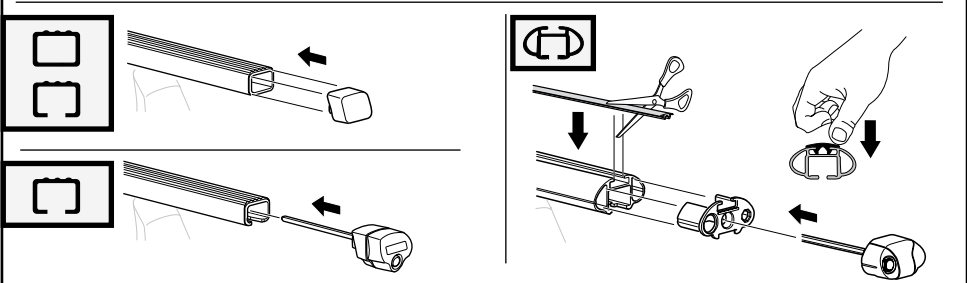
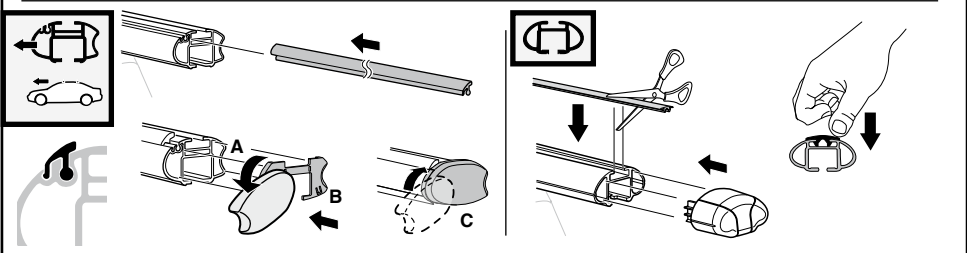
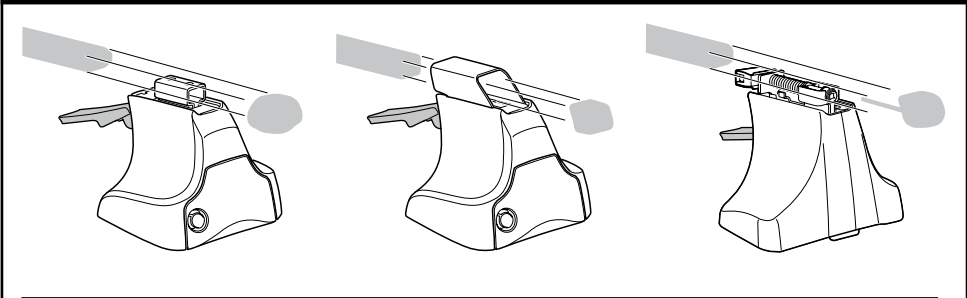
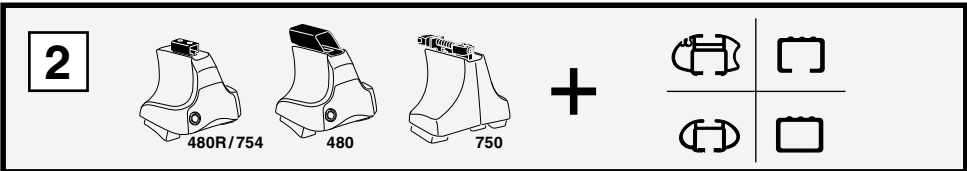
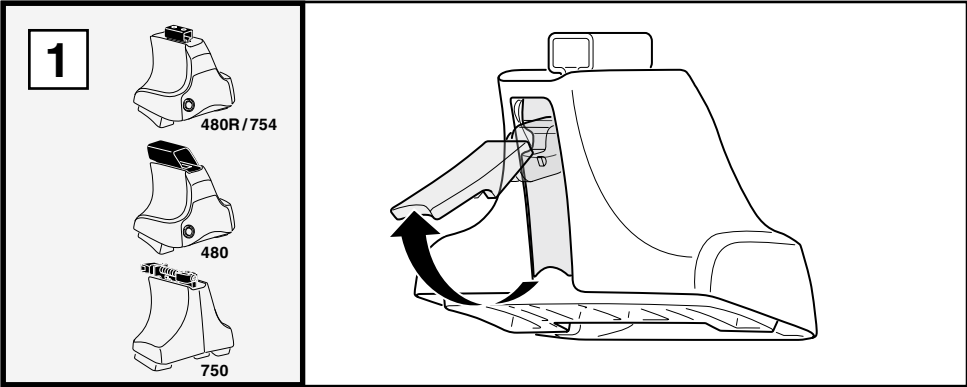

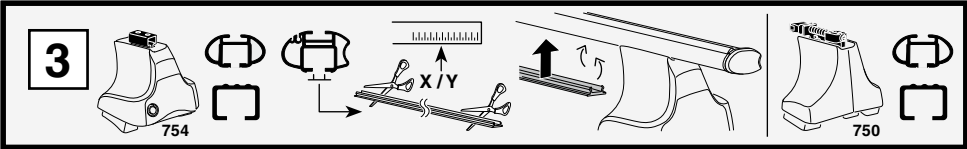

1

2

	X
NISSAN Dualis, 5-dr SUV, 07-	43,5
NISSAN Qashqai, 5-dr SUV, 07-	43,5

1

2

	Y
NISSAN Dualis, 5-dr SUV, 07-	40,5
NISSAN Qashqai, 5-dr SUV, 07-	40,5

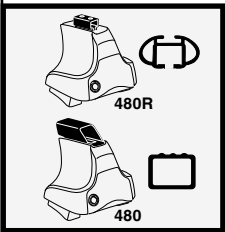

1

2

	X inch	X mm
NISSAN Dualis, 5-dr SUV, 07-	42 ³ / ₄ "	1086 mm
NISSAN Qashqai, 5-dr SUV, 07-	42 ³ / ₄ "	1086 mm

1

2

	Y inch	Y mm
NISSAN Dualis, 5-dr SUV, 07-	41 ⁵ / ₈ "	1056 mm
NISSAN Qashqai, 5-dr SUV, 07-	41 ⁵ / ₈ "	1056 mm

4

NISSAN Dualis, 5-dr SUV, 07-
NISSAN Qashqai, 5-dr SUV, 07-

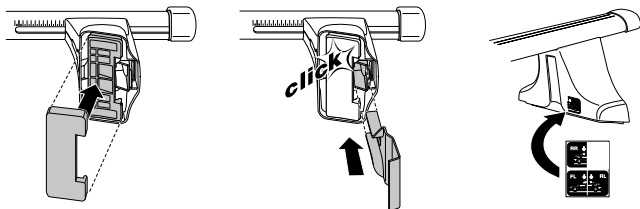
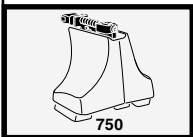
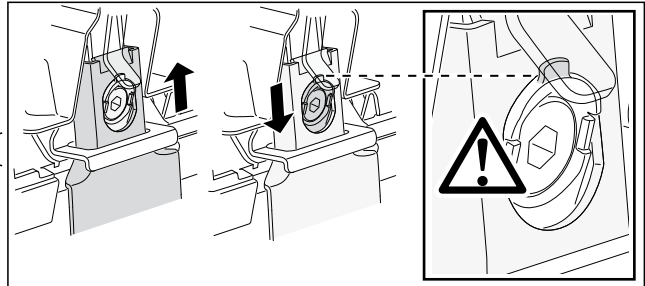
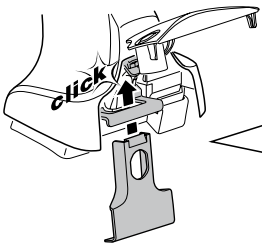
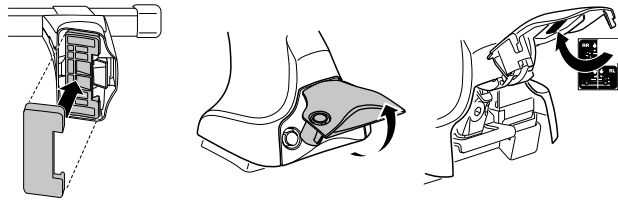
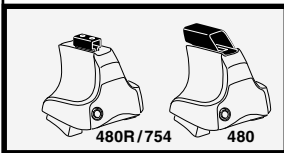
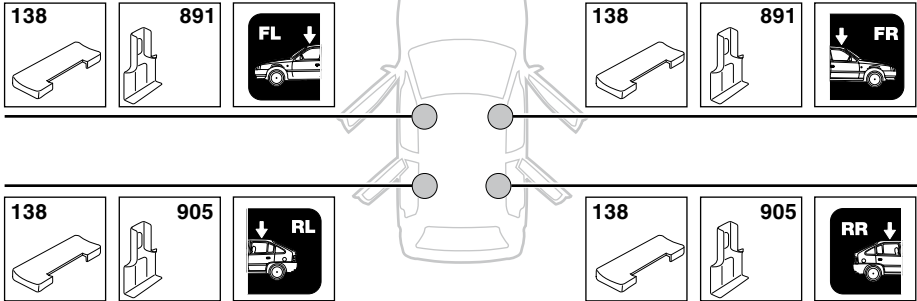

5

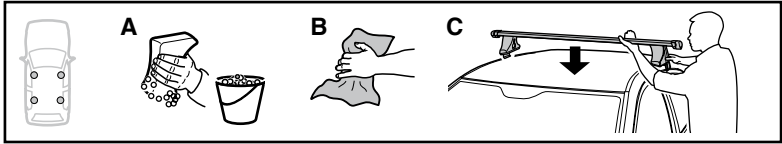

	X mm	Y mm	X inch	Y inch
NISSAN Dualis, 5-dr SUV, 07-	370 mm	770 mm	14 ⁵ / ₈ "	30 ³ / ₈ "
NISSAN Qashqai, 5-dr SUV, 07-	370 mm	770 mm	14 ⁵ / ₈ "	30 ³ / ₈ "

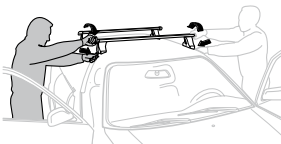
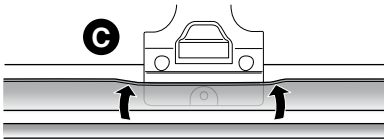
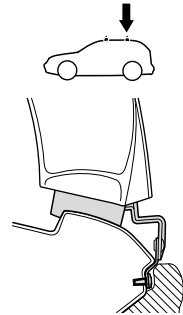
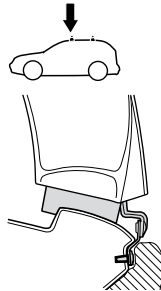
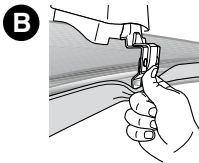
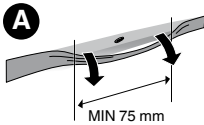
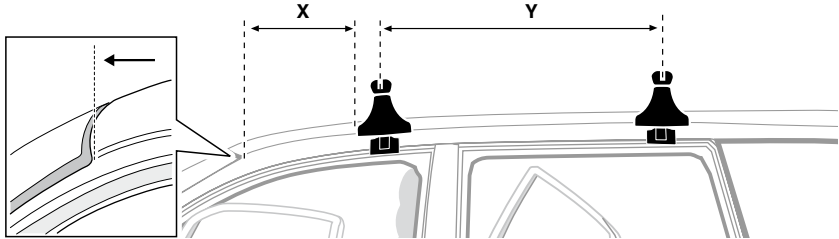

- | | | | |
|-------|--|-----|--|
| GB/US | Tighten alternately | CZ | Pokřetla bagazníka dokřečaj napřezmiennie. |
| D | Die Schrauben abwechselnd anziehen | SK | Dotiahujte striedavo. |
| F | Serrer alternativement chaque côté | SLO | Privijajte izmenično. |
| NL | Afwisselend aan de linker- en de rechterkant andraaien | HR | Naizmjenično zategnite |
| I | Alternare il serraggio delle viti | HU | Egymástól függetlenül szorítandó |
| E | Apretar alternativamente | GR | Σφιγγετε εναλλάξ |
| PT | Aperte alternadamente | TR | Dönüşümlü sıkın |
| S | Dra åt växelvis | 中文 | 交替拧紧 |
| FIN | Kierrä vuorotellen | 한국어 | 번갈아 가며 조이십시오. |
| EST | Pinguldage vaheldumisi | 日本語 | 交互に締め付けてください。 |
| LAT | Pievēciēt pamišus | ไทย | ขันน๊อตแบบสลับ |
| LIT | Užsukinėkite pakaitomis | | |
| LIT | Šrubby dokřečaj napřezmiennie | | |
| RU | Затягивайте попеременно | | |

6



480R/754



480

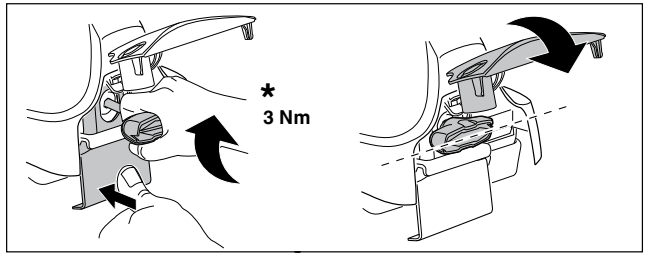
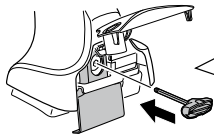

*
3 Nm

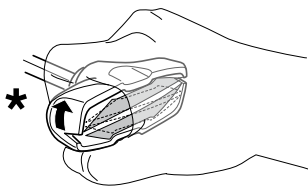

*

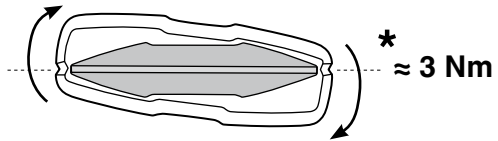

*
≈ 3 Nm

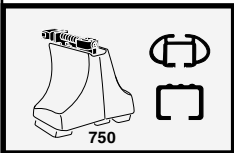
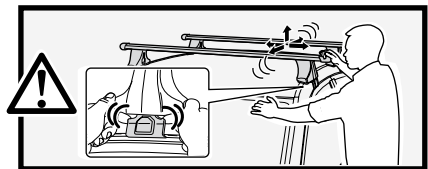

750

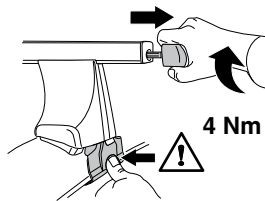

4 Nm

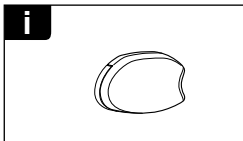
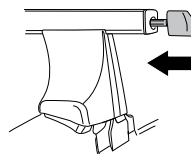

i

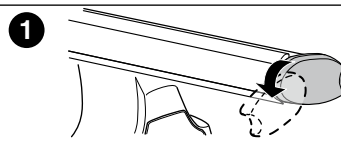

1

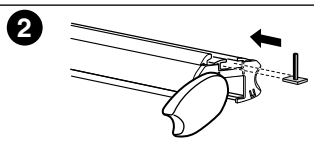

2

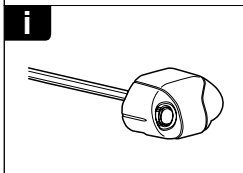

i

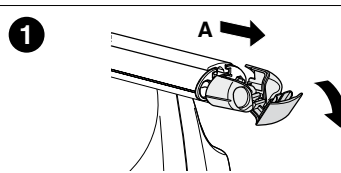

1

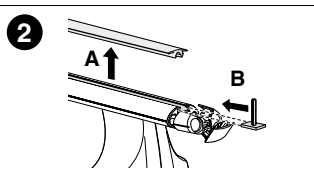

2

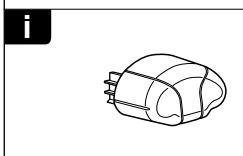

i

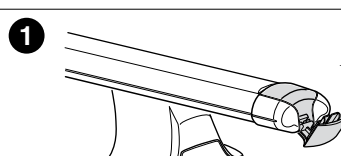

1

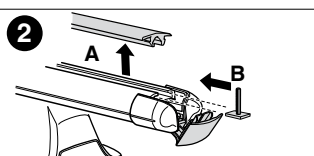

2

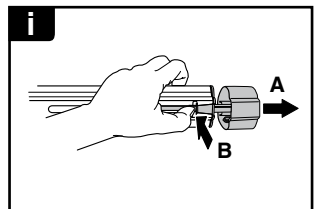
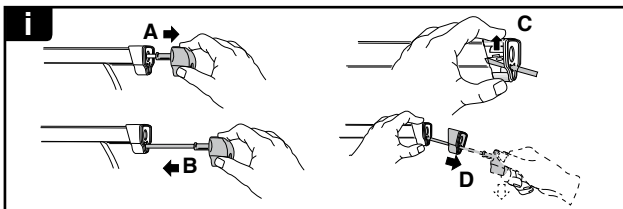
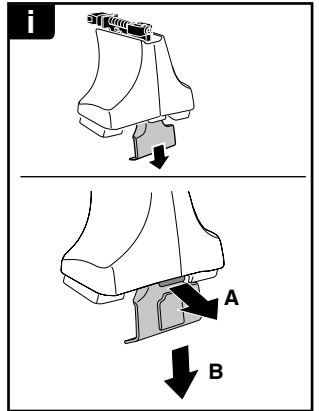
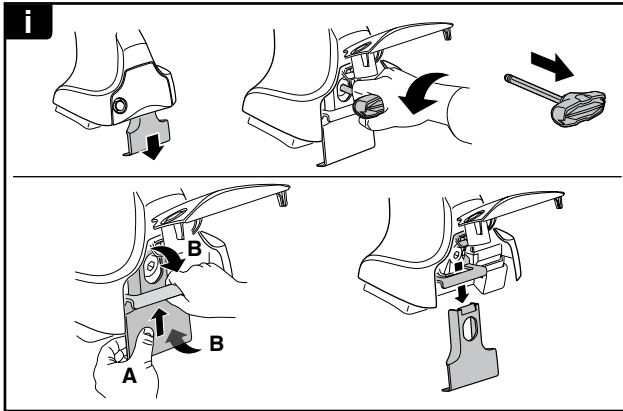
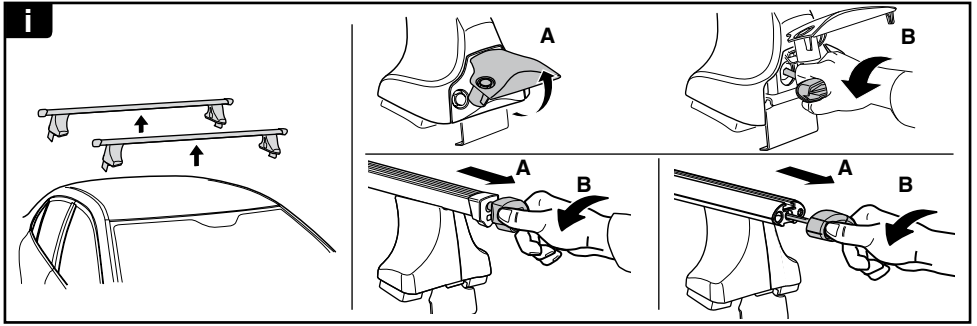

THULE
SWEDEN
**ONE
KEY
SYSTEM**

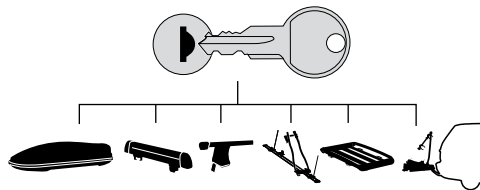

- 544 (x4)
- 596 (x6)
- 588 (x8)
- NA 510 (x10)
- EUR 452 (x12)
- ASIA

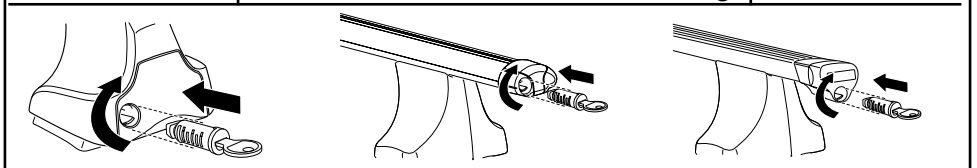

WW ▶ Thule Sweden AB, Box 69, 330 33 Hillerstorp, SWEDEN
NA ▶ Thule Inc., 42 Silvermine Road, Seymour, Connecticut 06483, USA

info@thule.com
customer.service@thule.com

www.thule.com