

# Kit 1302

- MAZDA 3**, 5-dr Hatchback, \*04-09
- MAZDA 6**, 4-dr Sedan, 02-04, 05-07
- MAZDA 6**, 5-dr Hatchback, 02-04, 05-07
- MAZDA 6**, 5-dr Estate, 02-05, 06-07
- MAZDA Atenza**, 4-dr Sedan, 02-04, 05-07 (JPN)
- MAZDA Atenza**, 5-dr Hatchback, 02-04, 05-07 (JPN)
- MAZDA Atenza Sport Wagon**, 5-dr Estate, 02-07 (JPN)

\*North America

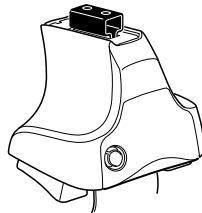

**754** Rapid System  
**480R** Rapid Traverse (North America)

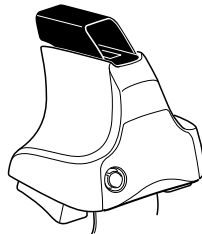
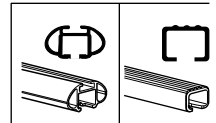

**480** Traverse (North America)

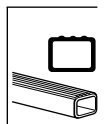

MAZDA 6, 4-dr Sedan, 02-04, 05-07  
 MAZDA 6, 5-dr Hatchback, 02-04, 05-07  
 MAZDA 6, 5-dr Estate, 02-05, 06-07

**Max.**  
**60 kg/132 lbs**

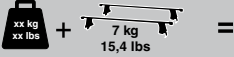

MAZDA 3, 5-dr Hatchback, \*04-09  
 MAZDA Atenza, 4-dr Sedan, 02-04, 05-07 (JPN)  
 MAZDA Atenza, 5-dr Hatchback, 02-04, 05-07 (JPN)  
 MAZDA Atenza Sport Wagon, 5-dr Estate, 02-07 (JPN)

**Max.**  
**40 kg/88 lbs**

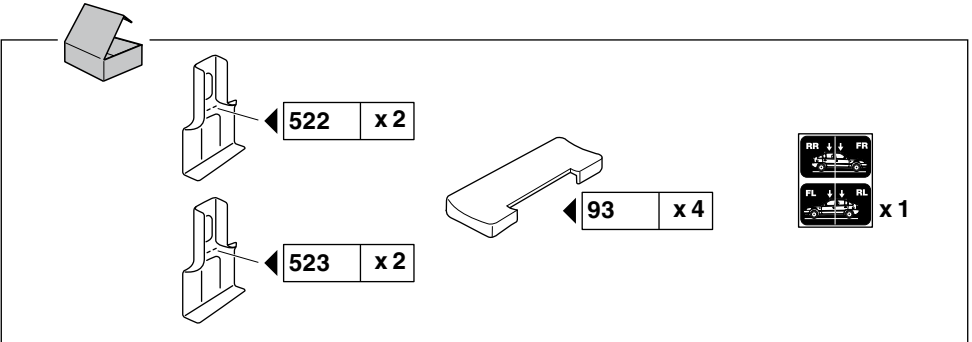
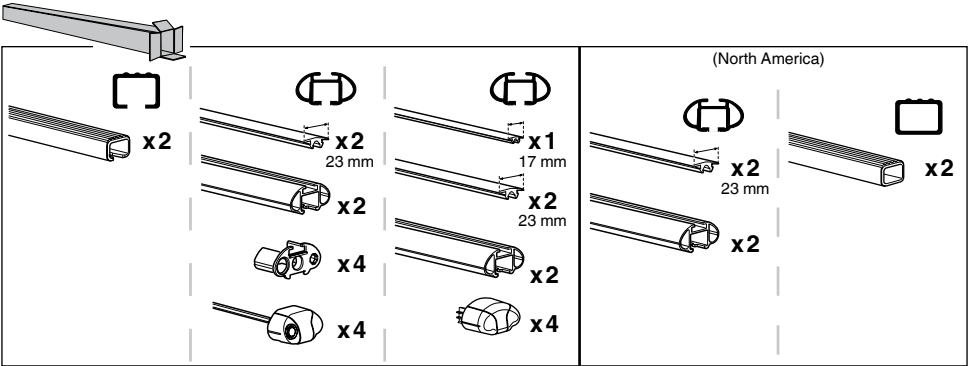
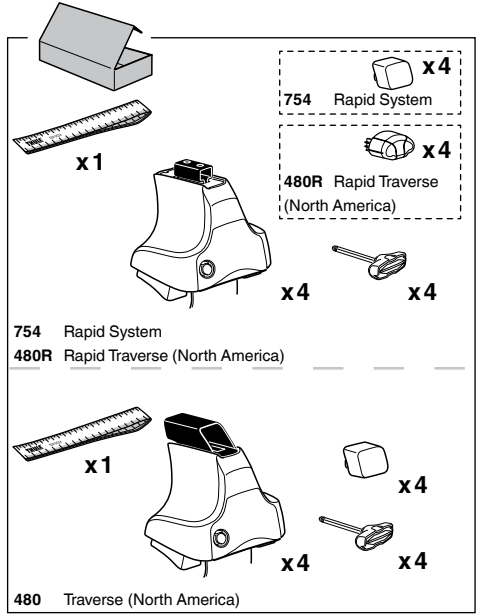
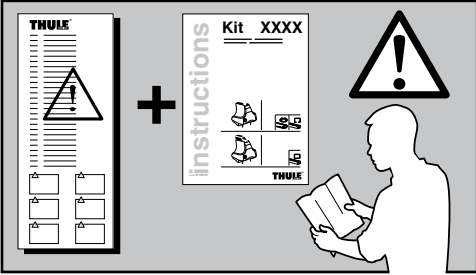
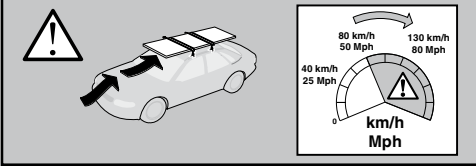

1

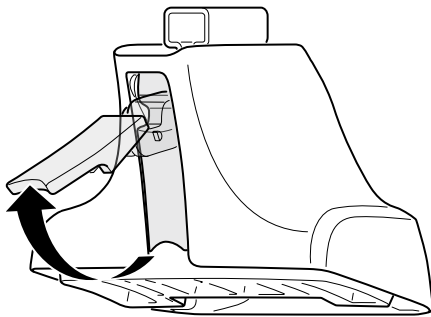

2



754 Rapid System  
480R Rapid Traverse  
(North America)

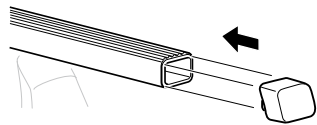
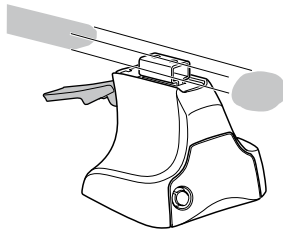

x4

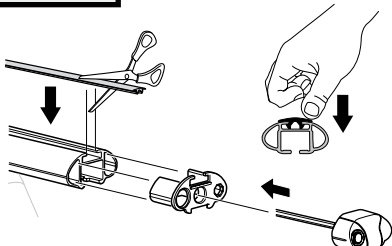

x4

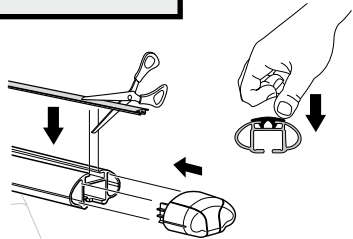
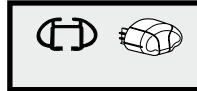

x4



480 Traverse  
(North America)

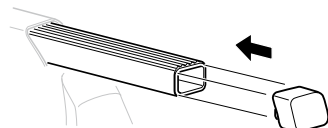
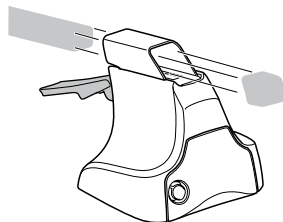

x4

**3**



754 Rapid System

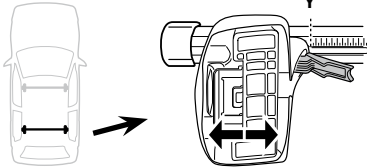
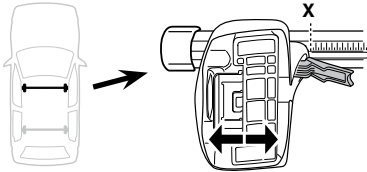

	X
<b>MAZDA 3</b> , 5-dr Hatchback, *04-09	36
<b>MAZDA 6</b> , 4-dr Sedan, 02-04, 05-07	32
<b>MAZDA 6</b> , 5-dr Hatchback, 02-04, 05-07	32
<b>MAZDA 6</b> , 5-dr Estate, 02-05, 06-07	31
<b>MAZDA Atenza</b> , 4-dr Sedan, 02-04, 05-07 (JPN)	32
<b>MAZDA Atenza</b> , 5-dr Hatchback, 02-04, 05-07 (JPN)	32
<b>MAZDA Atenza Sport Wagon</b> , 5-dr Estate, 02-07 (JPN)	31

	Y
<b>MAZDA 3</b> , 5-dr Hatchback, *04-09	34,5
<b>MAZDA 6</b> , 4-dr Sedan, 02-04, 05-07	30,5
<b>MAZDA 6</b> , 5-dr Hatchback, 02-04, 05-07	30,5
<b>MAZDA 6</b> , 5-dr Estate, 02-05, 06-07	29
<b>MAZDA Atenza</b> , 4-dr Sedan, 02-04, 05-07 (JPN)	30,5
<b>MAZDA Atenza</b> , 5-dr Hatchback, 02-04, 05-07 (JPN)	30,5
<b>MAZDA Atenza Sport Wagon</b> , 5-dr Estate, 02-07 (JPN)	29

**3**

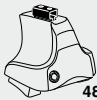

480R Rapid Traverse



480 Traverse



**(North America)**

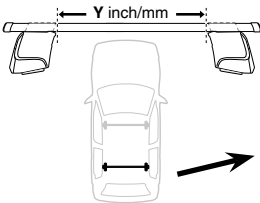
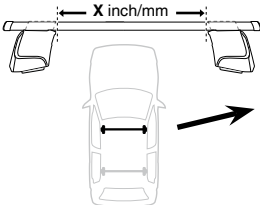

	X inch	X mm
<b>MAZDA 3</b> , 5-dr Hatchback, *04-09	39 <sup>7</sup> / <sub>8</sub> "	1013 mm
<b>MAZDA 6</b> , 4-dr Sedan, 02-04, 05-07	38 <sup>1</sup> / <sub>4</sub> "	971 mm
<b>MAZDA 6</b> , 5-dr Hatchback, 02-04, 05-07	38 <sup>1</sup> / <sub>4</sub> "	971 mm
<b>MAZDA 6</b> , 5-dr Estate, 02-05, 06-07	37 <sup>7</sup> / <sub>8</sub> "	961 mm
<b>MAZDA Atenza</b> , 4-dr Sedan, 02-04, 05-07 (JPN)	38 <sup>1</sup> / <sub>4</sub> "	971 mm
<b>MAZDA Atenza</b> , 5-dr Hatchback, 02-04, 05-07 (JPN)	38 <sup>1</sup> / <sub>4</sub> "	971 mm
<b>MAZDA Atenza Sport Wagon</b> , 5-dr Estate, 02-07 (JPN)	37 <sup>7</sup> / <sub>8</sub> "	961 mm

	Y inch	Y mm
<b>MAZDA 3</b> , 5-dr Hatchback, *04-09	39 <sup>1</sup> / <sub>4</sub> "	996 mm
<b>MAZDA 6</b> , 4-dr Sedan, 02-04, 05-07	38 <sup>1</sup> / <sub>4</sub> "	971 mm
<b>MAZDA 6</b> , 5-dr Hatchback, 02-04, 05-07	38 <sup>1</sup> / <sub>4</sub> "	971 mm
<b>MAZDA 6</b> , 5-dr Estate, 02-05, 06-07	37 <sup>7</sup> / <sub>8</sub> "	961 mm
<b>MAZDA Atenza</b> , 4-dr Sedan, 02-04, 05-07 (JPN)	38 <sup>1</sup> / <sub>4</sub> "	971 mm
<b>MAZDA Atenza</b> , 5-dr Hatchback, 02-04, 05-07 (JPN)	38 <sup>1</sup> / <sub>4</sub> "	971 mm
<b>MAZDA Atenza Sport Wagon</b> , 5-dr Estate, 02-07 (JPN)	37 <sup>7</sup> / <sub>8</sub> "	961 mm

**4**

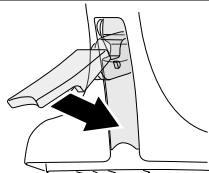

# 5

**MAZDA 3**, 5-dr Hatchback, \*04-09

**MAZDA 6**, 4-dr Sedan, 02-04, 05-07

**MAZDA 6**, 5-dr Hatchback, 02-04, 05-07

**MAZDA 6**, 5-dr Estate, 02-05, 06-07

**MAZDA Atenza**, 4-dr Sedan, 02-04, 05-07 (JPN)

**MAZDA Atenza**, 5-dr Hatchback, 02-04, 05-07 (JPN)

**MAZDA Atenza Sport Wagon**, 5-dr Estate, 02-07 (JPN)

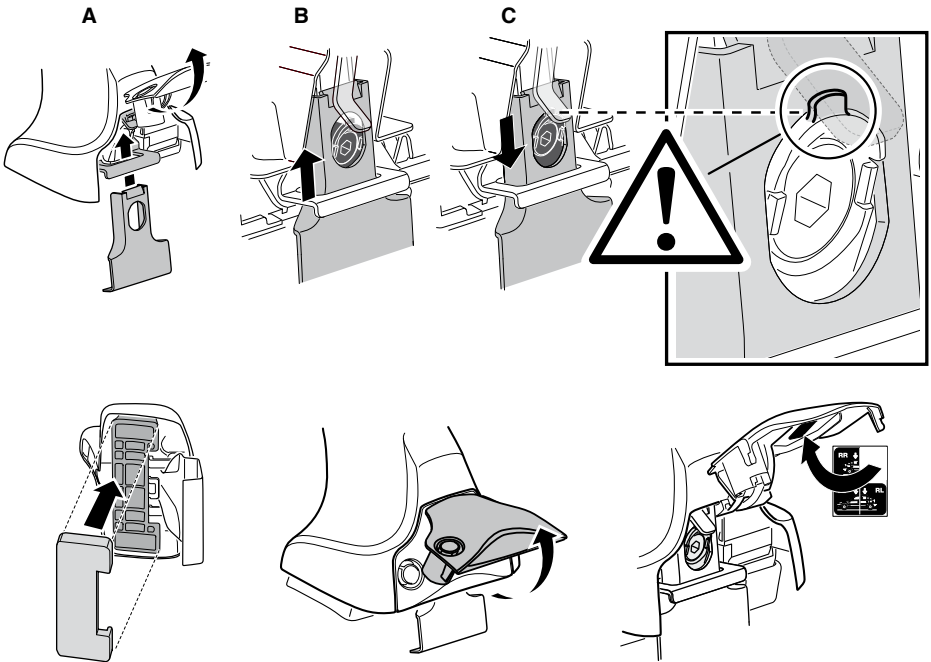
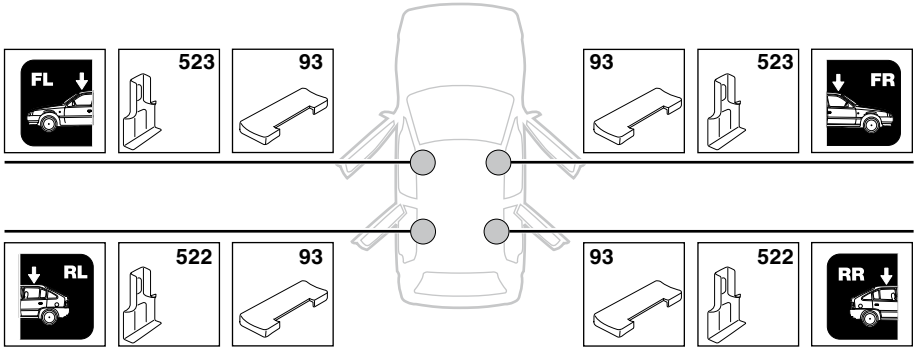

6

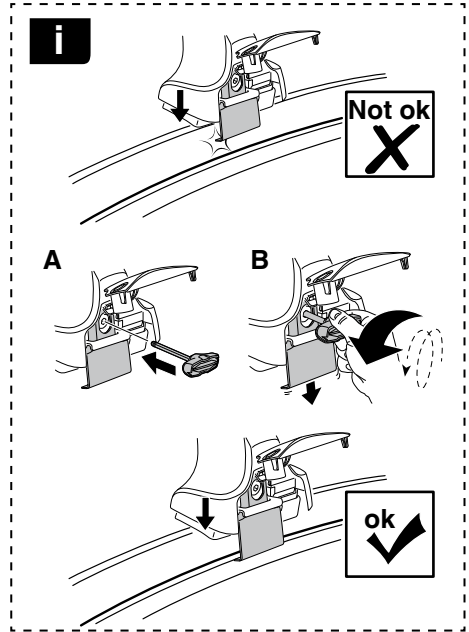
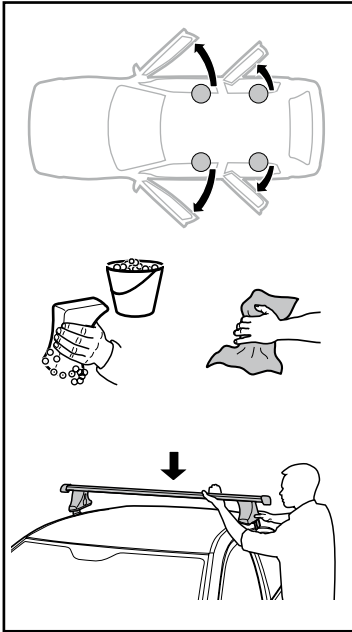

	X mm	Y mm	X inch	Y inch
<b>MAZDA 3</b> , 5-dr Hatchback, *04-09	254 mm	660 mm	10"	26"
<b>MAZDA 6</b> , 4-dr Sedan, 02-04, 05-07	250 mm	650 mm	9 <sup>7</sup> / <sub>8</sub> "	25 <sup>5</sup> / <sub>8</sub> "
<b>MAZDA 6</b> , 5-dr Hatchback, 02-04, 05-07	250 mm	650 mm	9 <sup>7</sup> / <sub>8</sub> "	25 <sup>5</sup> / <sub>8</sub> "
<b>MAZDA 6</b> , 5-dr Estate, 02-05, 06-07	435 mm	700 mm	17 <sup>1</sup> / <sub>8</sub> "	27 <sup>1</sup> / <sub>4</sub> "
<b>MAZDA Atenza</b> , 4-dr Sedan, 02-04, 05-07 (JPN)	250 mm	650 mm	9 <sup>7</sup> / <sub>8</sub> "	25 <sup>5</sup> / <sub>8</sub> "
<b>MAZDA Atenza</b> , 5-dr Hatchback, 02-04, 05-07 (JPN)	250 mm	650 mm	9 <sup>7</sup> / <sub>8</sub> "	25 <sup>5</sup> / <sub>8</sub> "
<b>MAZDA Atenza Sport Wagon</b> , 5-dr Estate, 02-07 (JPN)	435 mm	700 mm	17 <sup>1</sup> / <sub>8</sub> "	27 <sup>1</sup> / <sub>4</sub> "

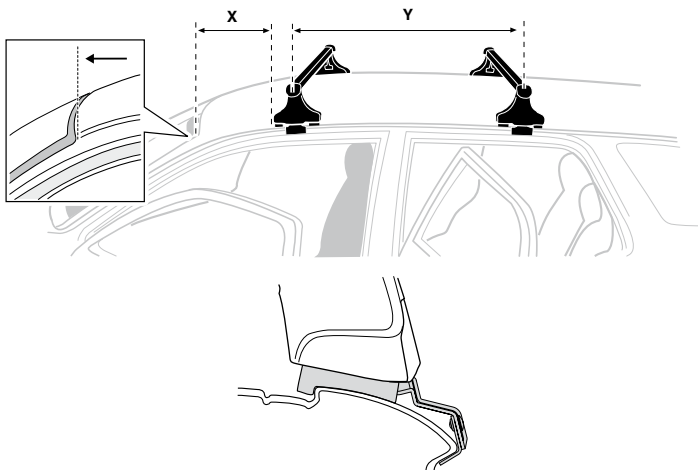

7

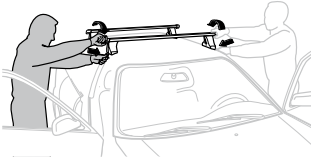

**GB/US** Tighten alternately  
**D** Die Schrauben abwechselnd anziehen  
**F** Serrer alternativement chaque côté  
**NL** Afwisselend aan de linker- en de rechterkant aandraaien  
**I** Alternare il serraggio delle viti  
**E** Apertar alternativamente  
**PT** Aperte alternadamente  
**S** Dra åt växelvis  
**FIN** Kierrä vuorotellen  
**EST** Pinguldage vaheldumisi  
**LAT** Pievelciēt pamišus  
**LIT** Užsukinėkite pakaitomis  
**PL** Śruby dokręcaj naprzemiennie  
**RU** Затягивайте попеременно

**CZ** Pokrétla bagazníka dokręcaj dokręcaj naprzemiennie.  
**SK** Doťahujte striedavo  
**SLO** Privijajte izmenično.  
**HR** Naizmjenično zategnite  
**HU** Egymástól függetlenül szorítandó  
**GR** Σφιγγεται εναλλάξ  
**TR** Dönüşümlü sıkın

**中文** 交替拧紧

**한국어** 번갈아 가며 조이십시오.

**日本語** 交互に締め付けてください。

**ไทย** ชั้้นในแบบสลับ

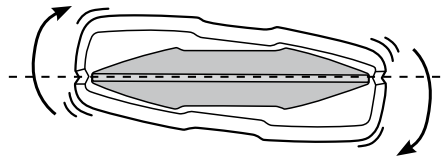
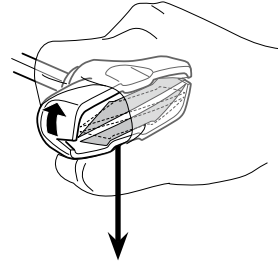
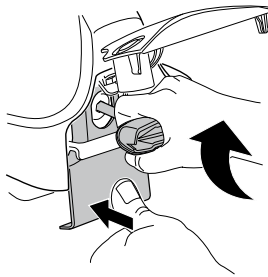
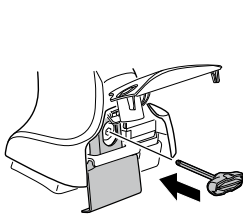

≈ 3 Nm

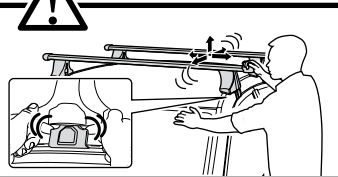
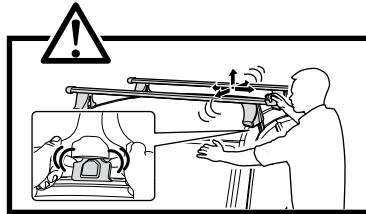
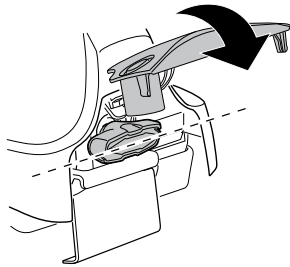

8



x1  
17 mm

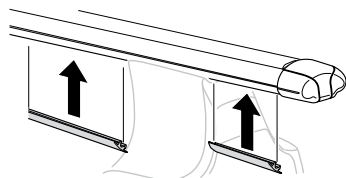

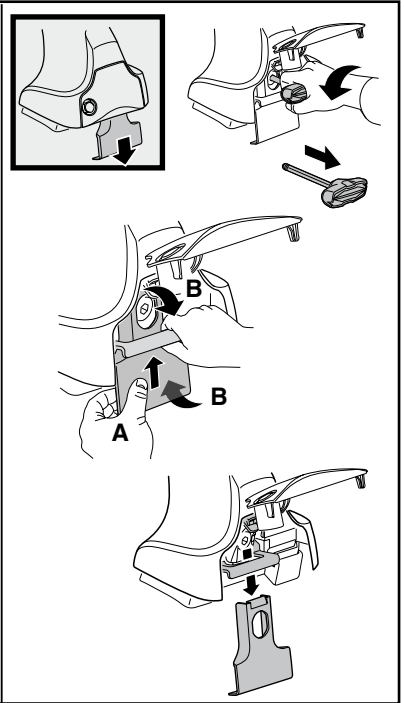
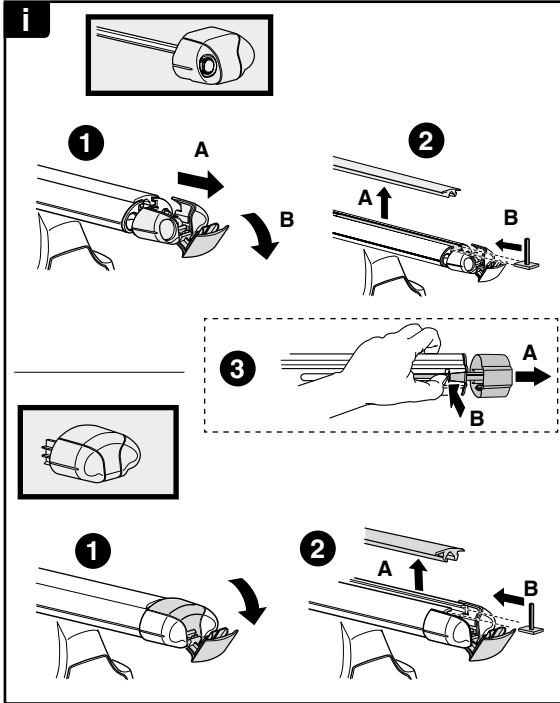

**THULE**  
SWEDEN  
**ONE  
KEY  
SYSTEM**

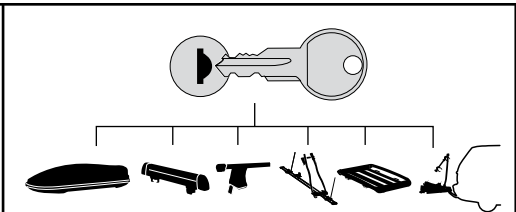

		(x4)
		(x6)
		(x8)
NA		(x10)
EUR		(x12)
ASIA		



WW ▶ Thule Sweden AB, Box 69, 330 33 Hillerstorp, SWEDEN  
NA ▶ Thule Inc., 42 Silvermine Road, Seymour, Connecticut 06483, USA

info@thule.com  
customer.service@thule.com

www.thule.com