







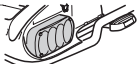

Thule EuroPower 915, 916

> **Instructions**

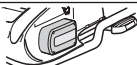

	<b>Max 30 kg</b>		<b>915/916 Max 60 kg</b>			
<b>915020</b>				<b>CITY CRASH</b> Complies with ISO norm		<b>19 kg</b>
<b>916020</b>		—		<b>CITY CRASH</b> Complies with ISO norm		<b>18,9 kg</b>

**EN** Tow bar-mounted bike carrier  
**DE** Fahrradträger für die Anhängerkupplung  
**FR** Porte-vélos sur boule d'attelage  
**NL** Fietsdrager voor op de trekhaak  
**IT** Portabicicli da installare sul gancio da traino  
**ES** Portabicicletas de bola de remolque  
**PT** Suporte para bicicleta para engate  
**SV** Dragkroksmonterad cykelhållare  
**DK** Cykelholder, der er monteret på anhængertræk  
**NO** Hengerfestemonteerte lasteholdere  
**FI** Vetokoukkuun kiinnitettävä polkupyöräteline  
**ET** Haakekonksule paigaldatav jalgrattahoidik  
**LV** Uz piekabes āķa uzstādāms velosipēdu turētājs  
**LT** Prie gražūlo tvirtinami dviračių laikikliai  
**PL** Bagażnik rowerowy montowany na haku holowniczym  
**RU** Устанавливаемое на фаркопе крепление для велосипедов

**UK** Багажник для велосипедів, що монтується на буксирній штанзі  
**BG** Багажник за велосипеди, монтиран на теглича  
**CS** Nosič jízdních kol s montáží na tažné zařízení  
**SK** Nosič bicyklov s montážou na ťažné zariadenie  
**SL** Prtljažnik za kolesa za na vlečno kljuko  
**HR/BIH** Nosač bicikla koji se postavlja na kuku za vuču  
**RO** Suport pentru bicicletă montat pe bara de tracțiune  
**HU** Vonóhorogra szerelhető kerékpártartó  
**EL** Σχάρα ποδηλάτου κοτσοδόρου  
**TR** Çeki demirine bağlanan bisiklet taşıyıcı  
**HE** תא המנוע לרכיבת אופניים על כדור הרכיבה  
**AR** حامل الدراجة للتثبيت على قضيب الفطر  
**ZH** 拖杆安装式托架  
**JA** トウバーマウント型サイクルキャリア  
**KO** 트루바 장착 자전거 캐리어  
**TH** ครงยึดจับจักรยานแบบติดตั้งกับอุปกรณ์ลากพ่วงท้ายรถ

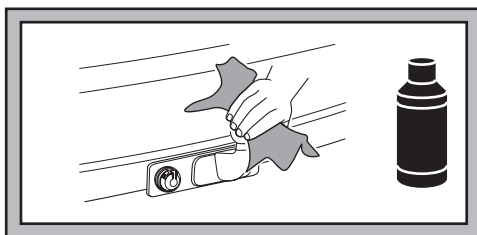
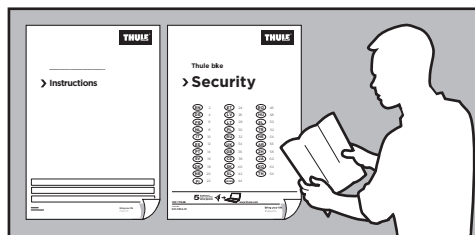
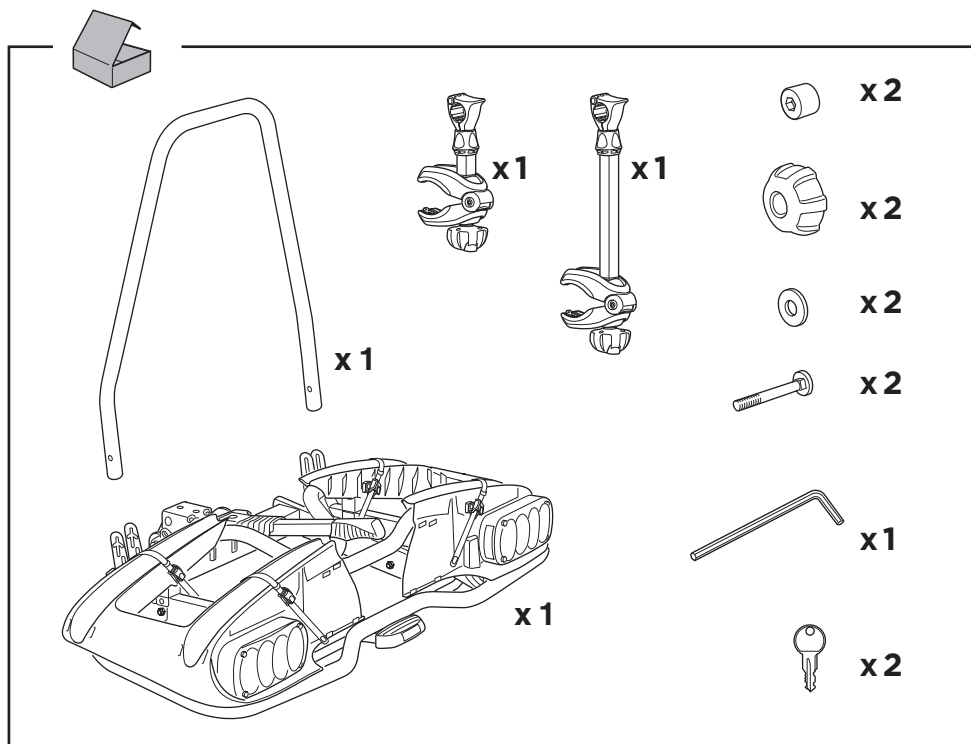



**D.1** →

Aluminium  
oder GGG40

Aluminium  
or GGG40

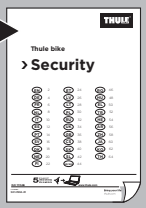
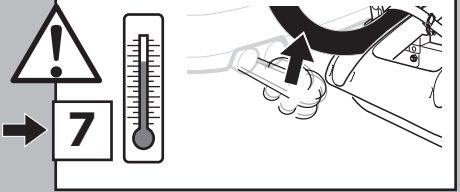
→ **7**

**i**



= **max 30 kg** x2

**Stützlast beachten**  
**Note towball capacity**

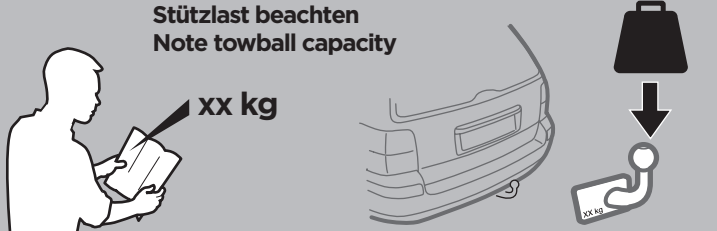

xx kg

xx kg

**\*** Min  
Ø28,5mm

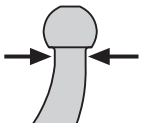

max ↓ xx kg	915	x 2 916	x 2
40 kg	19 kg	Max 21 kg	Max 21,1 kg
50 kg		Max 31 kg	Max 31,1 kg
60 kg		Max 41 kg	Max 41,1 kg
65 kg		Max 46 kg	Max 46,1 kg
70 kg		Max 51 kg	Max 51,1 kg
75 kg		Max 56 kg	Max 56,1 kg
>80 kg		Max 60 kg*	Max 60 kg*

1

x2

x2

x2

x2

x1

x1

x1

i

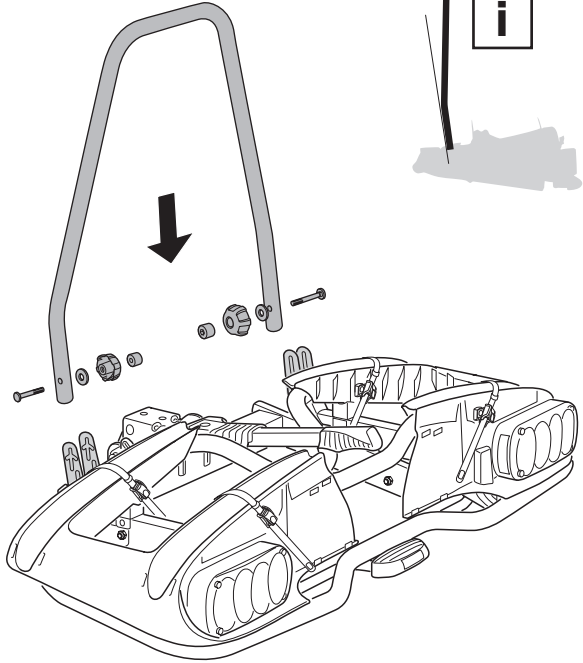
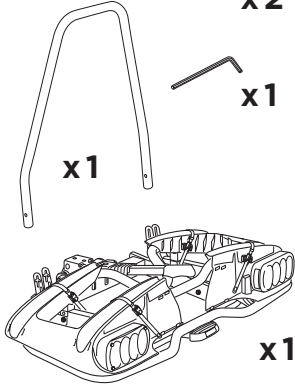

A

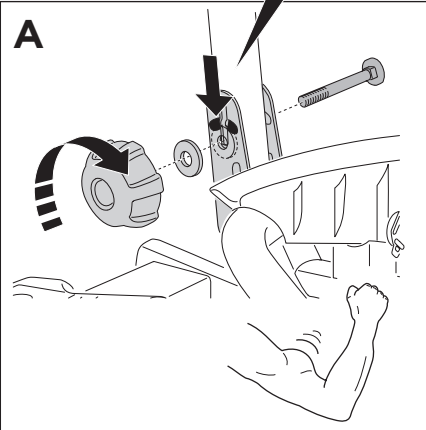

B

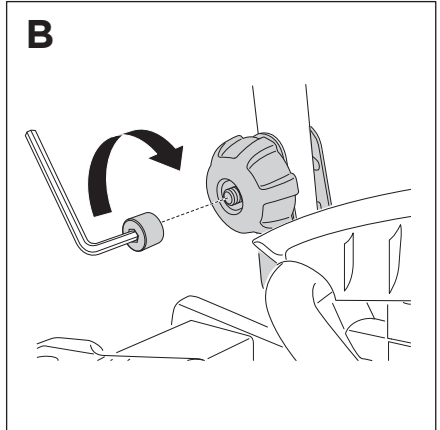

2

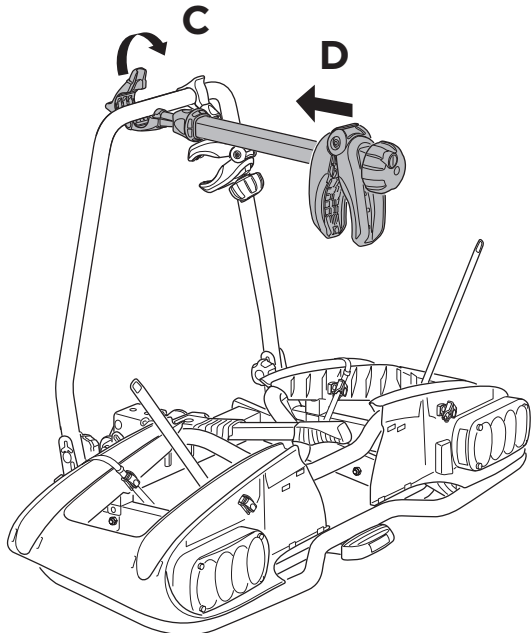
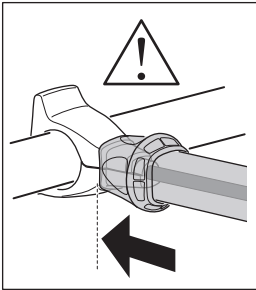
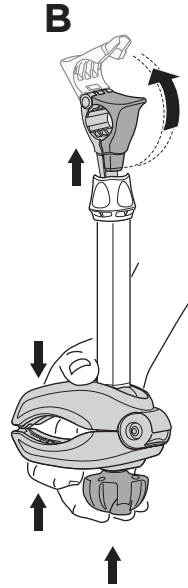
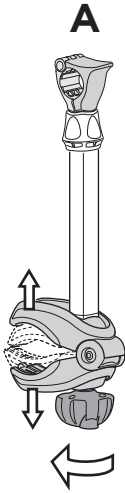
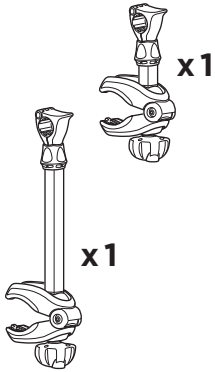

3

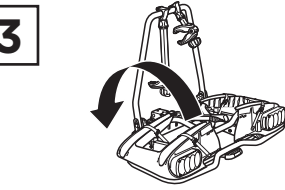

AB CD 123

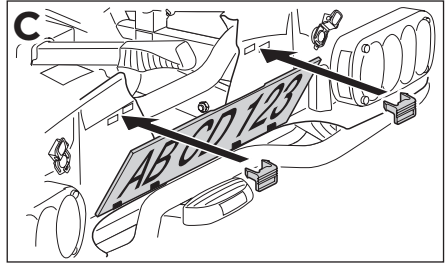
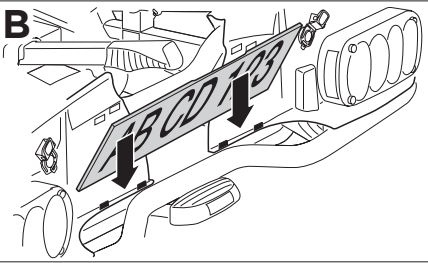
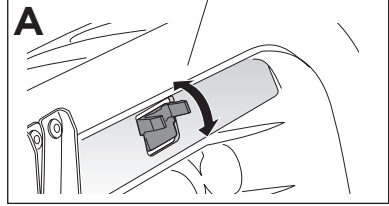
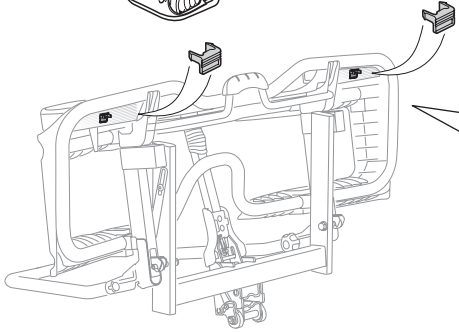

4

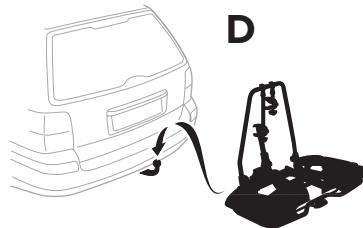
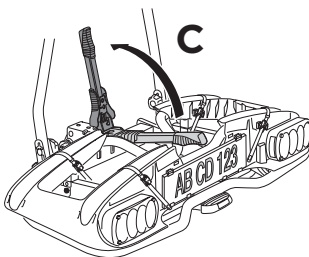
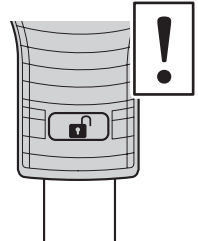
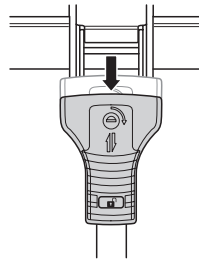
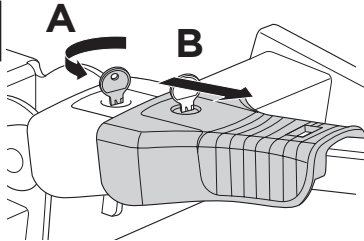

5

> 65 mm

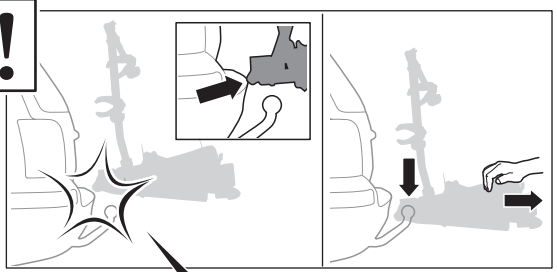
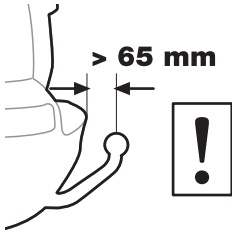

**Tips!**

50913

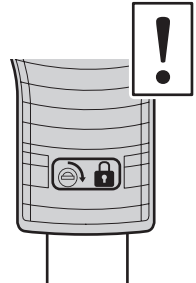
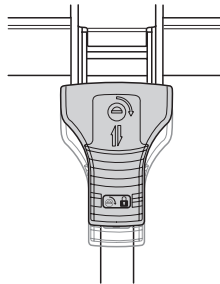
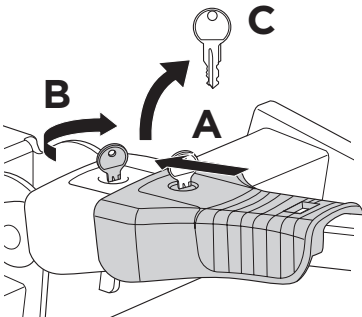
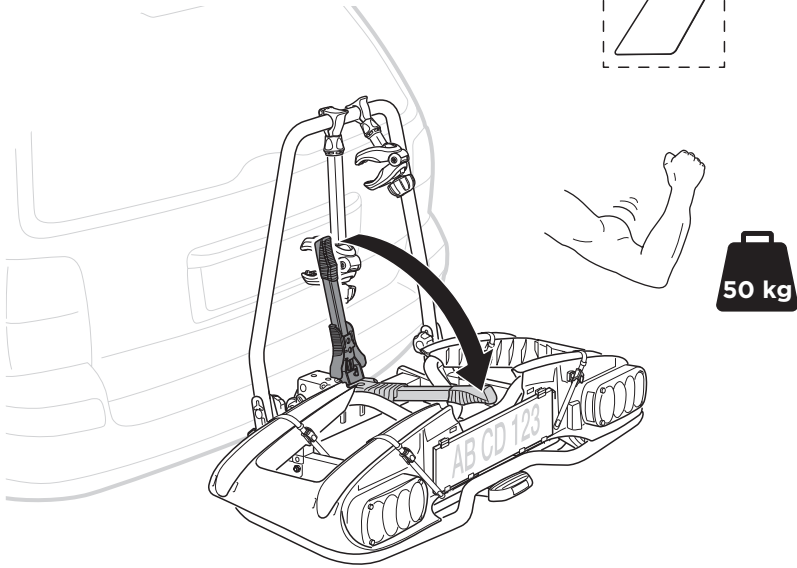
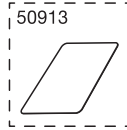

6

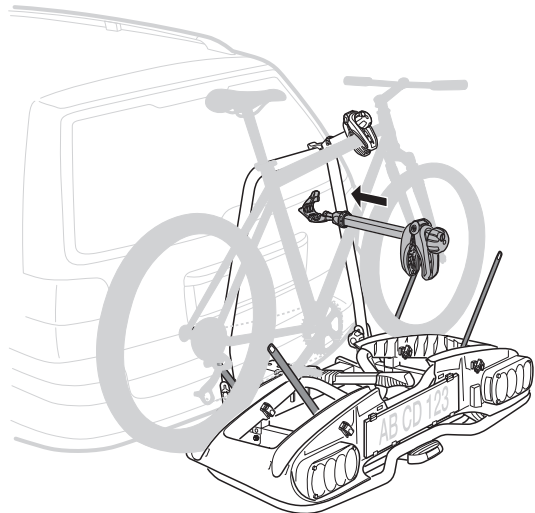
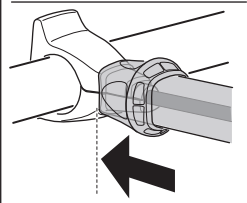
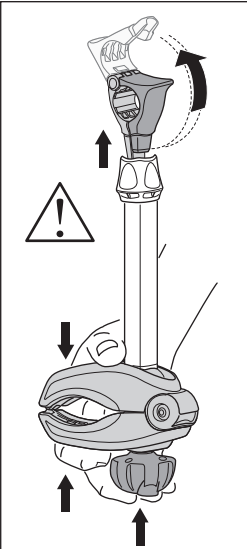
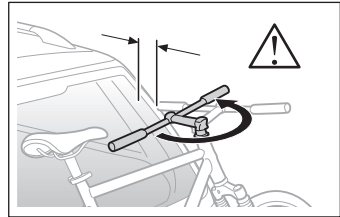
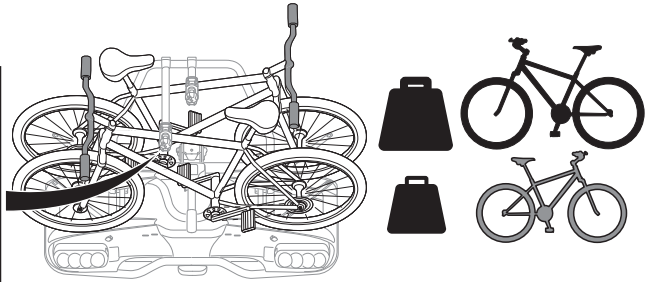
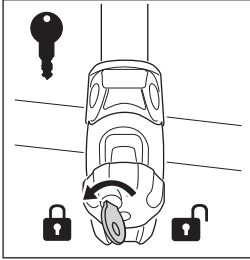



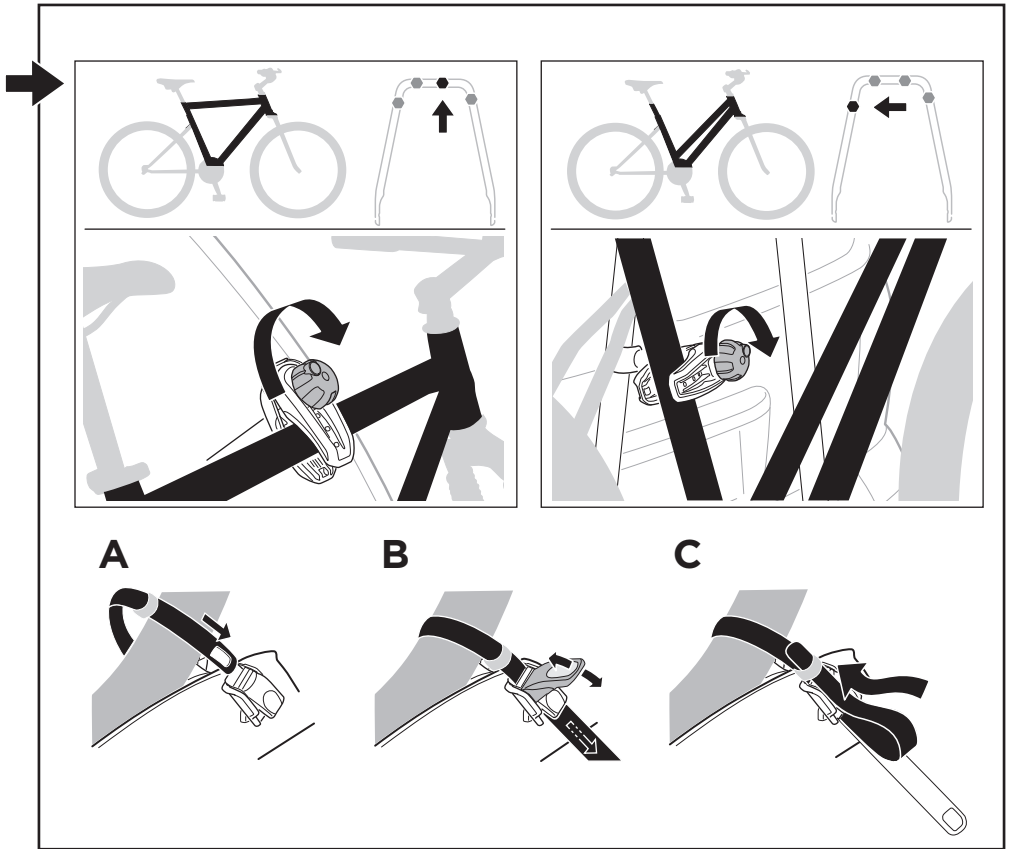

EN Accessories

FR Accessoires

DE Zubehör

NL Accessoires

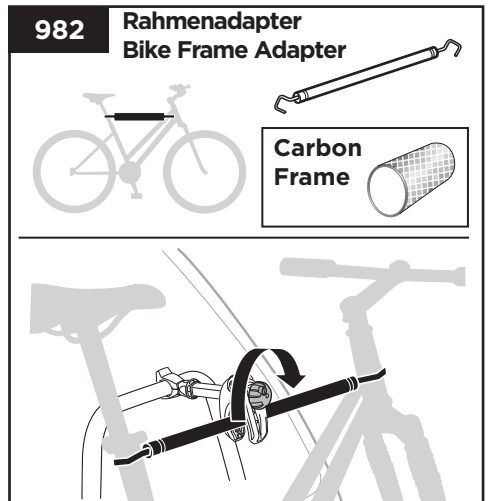
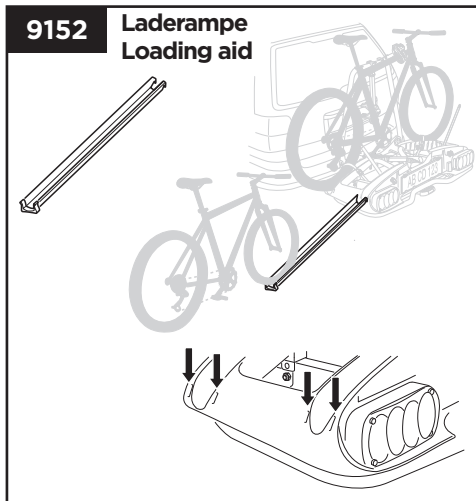

7

915:13-pin

Not ok



ok



90°



B 90°

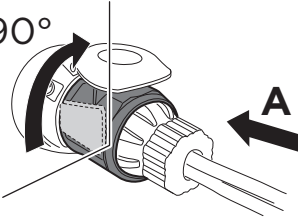

916:7-pin

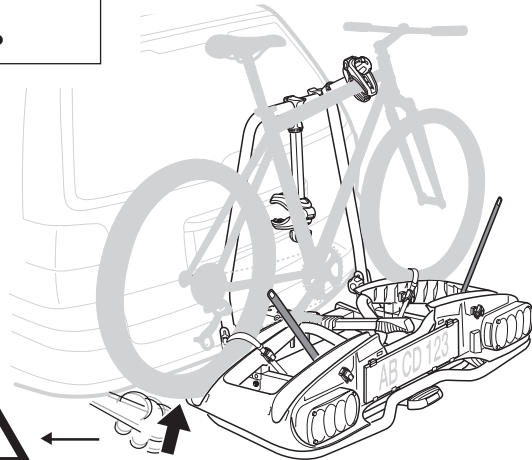
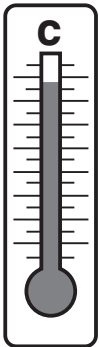
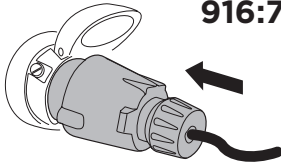

i

+

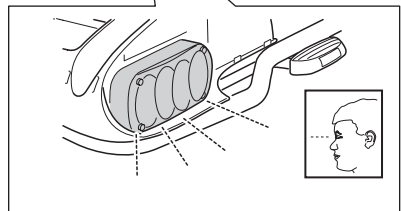

**i**

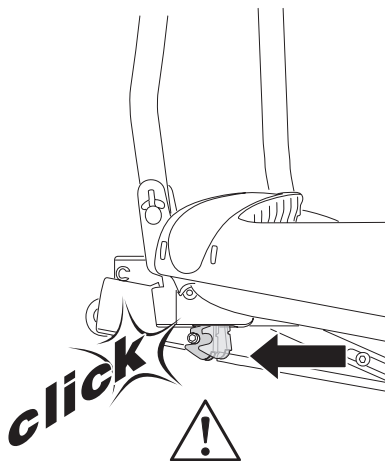
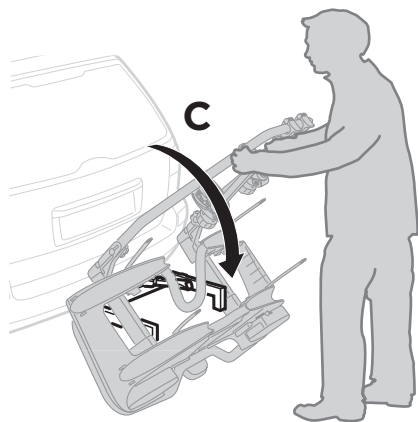
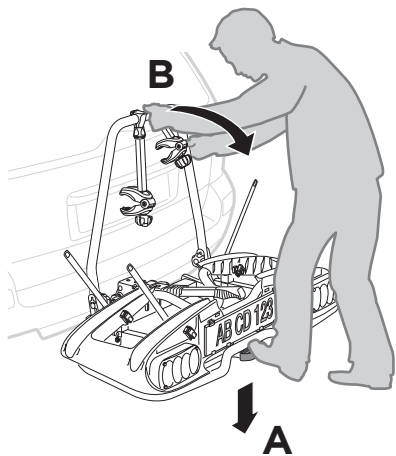
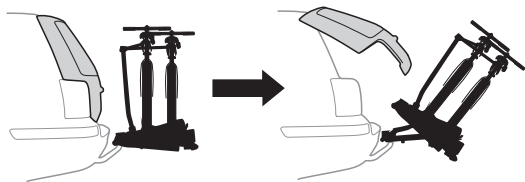

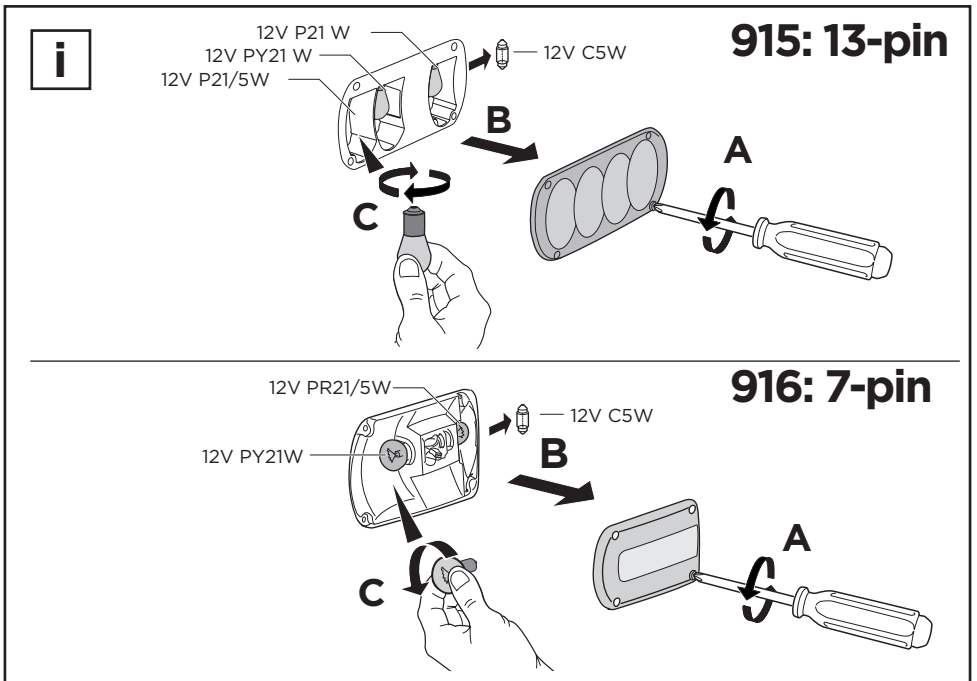
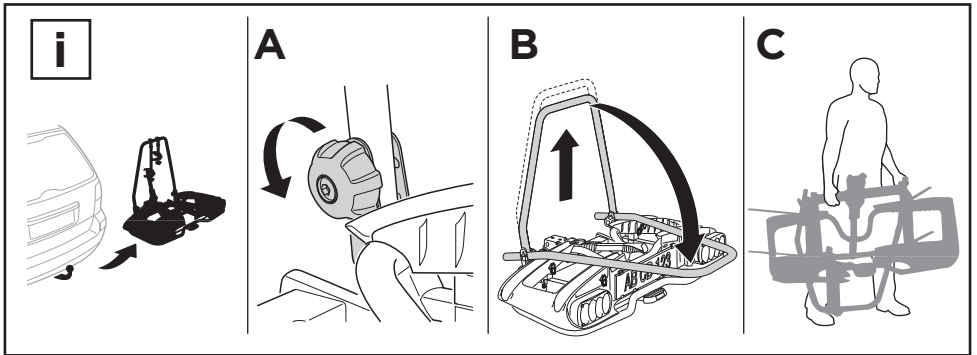
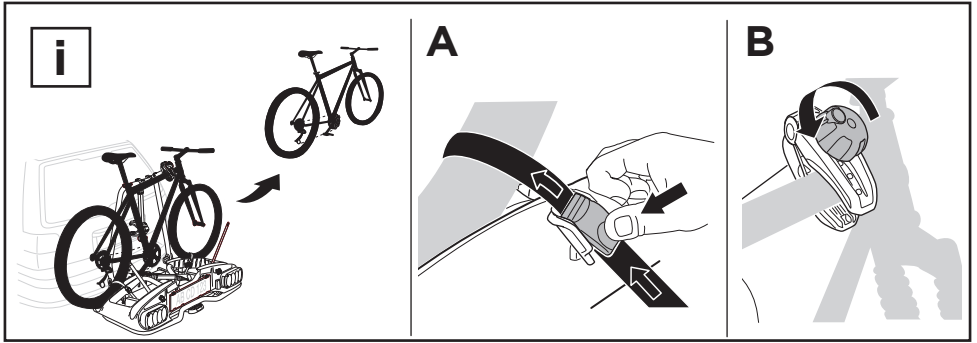

<b>EN</b> Adjustment	<b>DK</b> Justering	<b>UK</b> Регулювання	<b>EL</b> Ρύθμιση
<b>DE</b> Afstelling	<b>NE</b> Justering	<b>BG</b> Регулиране	<b>TR</b> Ayarlama
<b>FR</b> Réglage	<b>FI</b> Säätäminen	<b>CS</b> Nastavení	<b>AR</b> ضبط
<b>NL</b> aanpassing	<b>ET</b> Reguleerimine	<b>SK</b> Nastavenie	<b>HE</b> כווןן
<b>IT</b> Regolazione	<b>LV</b> Regulēšana	<b>SL</b> Nastavitev	<b>ZH</b> 調整
<b>ES</b> Ajuste	<b>LT</b> Reguliavimas	<b>HR/BiH</b> Podešenje	<b>JA</b> 調整
<b>PT</b> Ajuste	<b>PL</b> Regulacja	<b>RO</b> Reglare	<b>KO</b> 조정
<b>SV</b> Justering	<b>RU</b> Регулировка	<b>HU</b> Beállítás	<b>TH</b> การปรับ

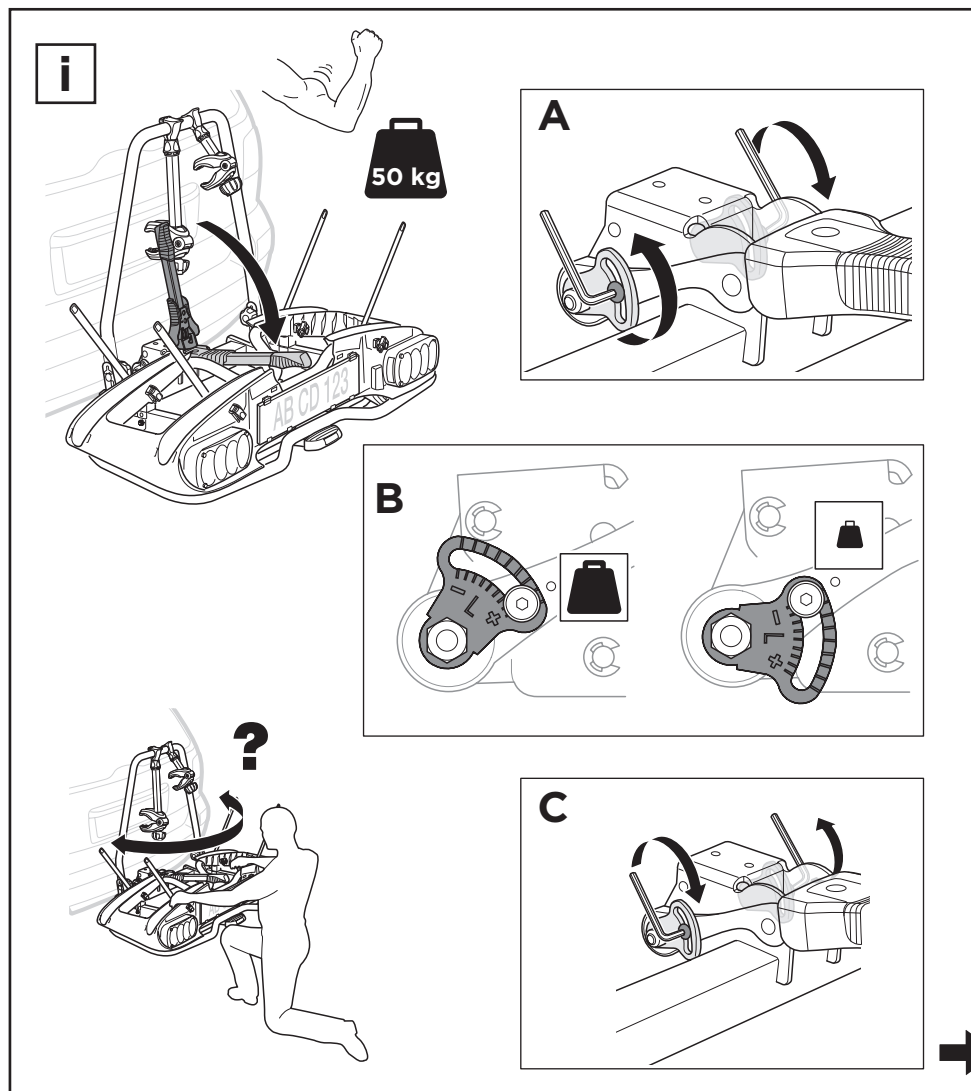

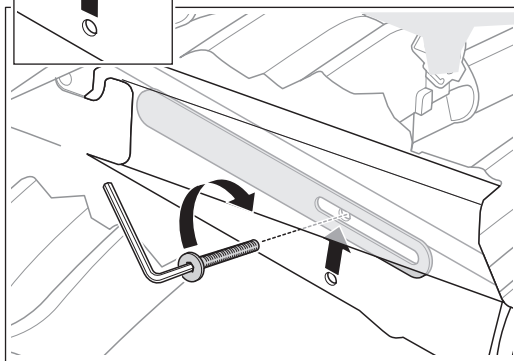
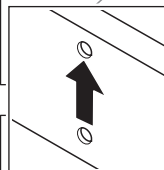
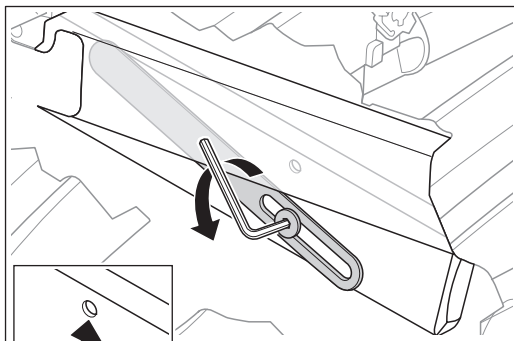
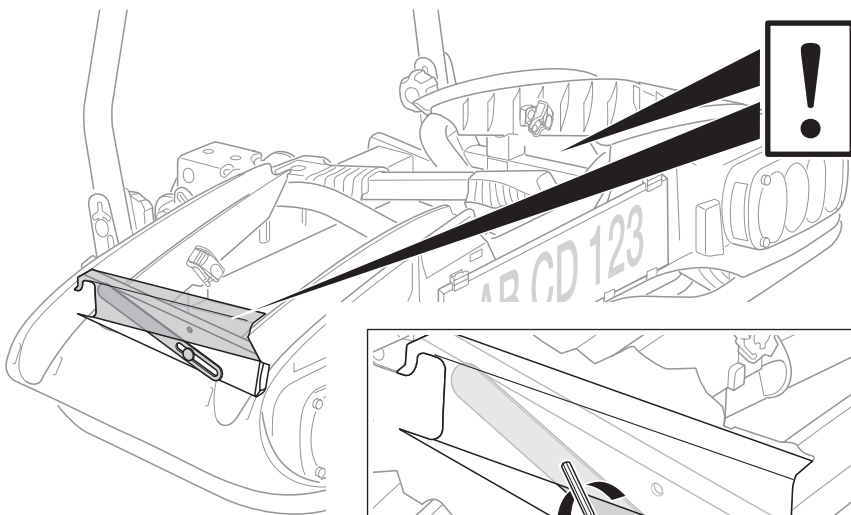
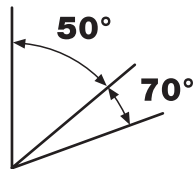
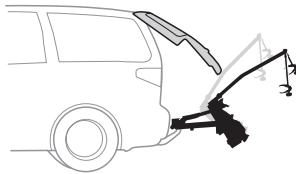
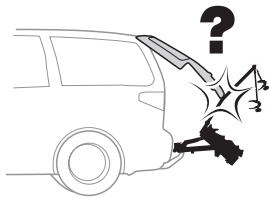

<b>EN</b> Accessories	<b>DK</b> Tilbehør	<b>UK</b> Аксессуары	<b>EL</b> Εξαρτήματα
<b>DE</b> Zubehör	<b>NE</b> Tilbehør	<b>BG</b> Принадлежности	<b>TR</b> Aksesuarlar
<b>FR</b> Accessoires	<b>FI</b> Lisävarusteet	<b>CS</b> Doplňky	<b>الملاحق</b> <b>AR</b>
<b>NL</b> Accessoires	<b>ET</b> Lisavarustus	<b>SK</b> Príslušenstvo	<b>אביזרים</b> <b>HE</b>
<b>IT</b> Accessori	<b>LV</b> Piederumi	<b>SL</b> Dodatki	<b>ZH</b> 附件
<b>ES</b> Accesorios	<b>LT</b> Priedai	<b>HR/BiH</b> Dodaci	<b>JA</b> アクセサリー
<b>PT</b> Acessórios	<b>PL</b> Akcesoria	<b>RO</b> Accesorii	<b>KO</b> 액세서리
<b>SV</b> Tillbehör	<b>RU</b> Аксессуары	<b>HU</b> Tartozékok	<b>TH</b> อุปกรณ์เสริม

**9902** **3. Bremsleuchte**  
**3rd Brake-light**

ok  
✓

**915**



Not ok  
✗

**916**

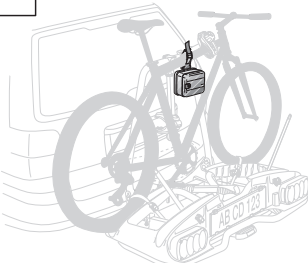

**9772** **Felgenadapter**  
**Road Bike Adapter**



**538** **Kabelschloss**  
**Locking wire**

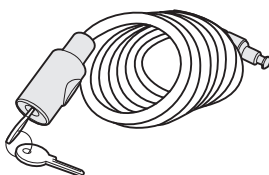

**9152** **Laderampe**  
**Loading aid**





**982** **Rahmenadapter**  
**Bike Frame Adapter**



**Carbon**  
**Frame**

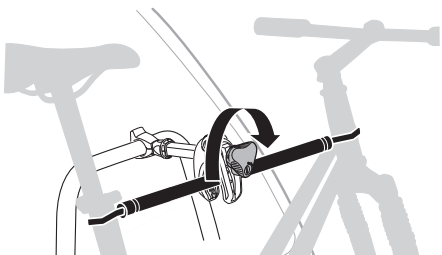



9771

Wandhalter  
Wall Hanger

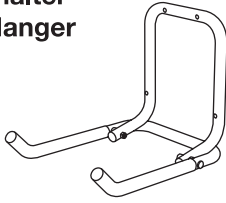

528

AcuTight Drehknopf mit  
Drehmomentbegrenzer  
AcuTight Torque Limiter Knob



9906

7-zu-13 pol Adapter  
7-to-13 pin Adapter

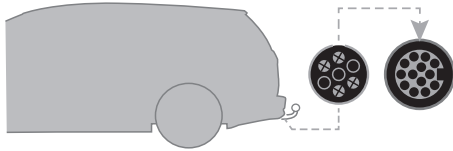

9907

13-zu-7 pol Adapter  
13-to-7 pin Adapter

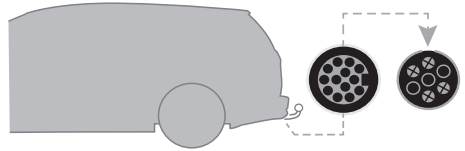

## Thule One-Key System

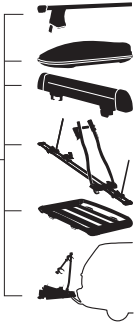

544 x4  
596 x6  
588 x8  
452 x12

9762

Neutrales kennzeichen  
Temporary registration plate

